

FRONT FRAME AWD COMPONENTS

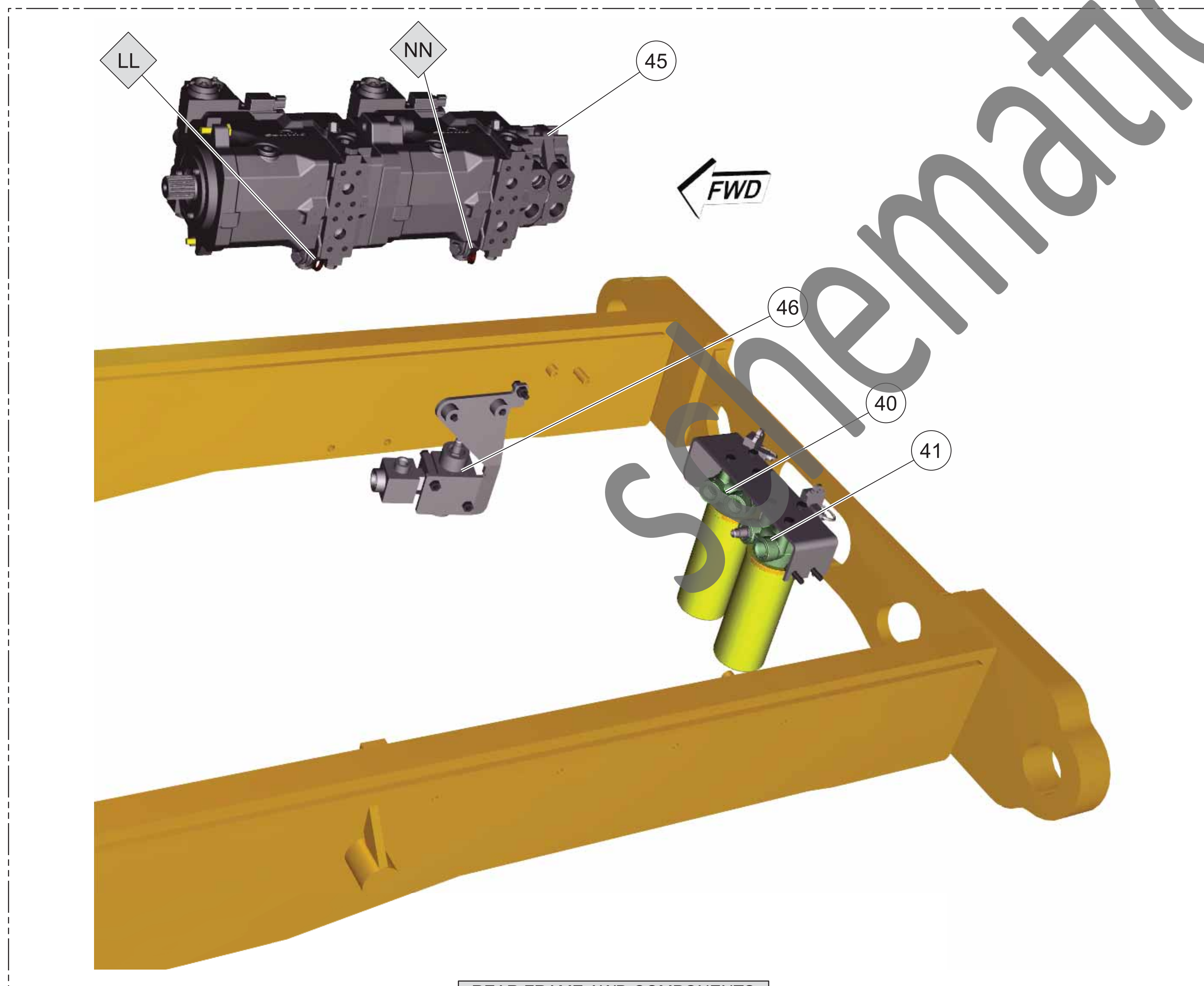

REAR FRAME AWD COMPONENTS

Schematic

12M, 120M, 140M, and 160M Series 2 Motor Grader Hydraulic System

12M: F9B1-UP F9M1-UP R9P1-UP R9S1-UP	120M: M921-UP M9C1-UP M9H1-UP R9N1-UP R9W1-UP	140M: M9D1-UP M9G1-UP M9J1-UP R9M1-UP	160M: M9E1-UP M9K1-UP R9L1-UP R9T1-UP
---	---	--	--

Volume 2 of 2: All Wheel Drive

© 2013 Caterpillar, All Rights Reserved

Printed in U.S.A.

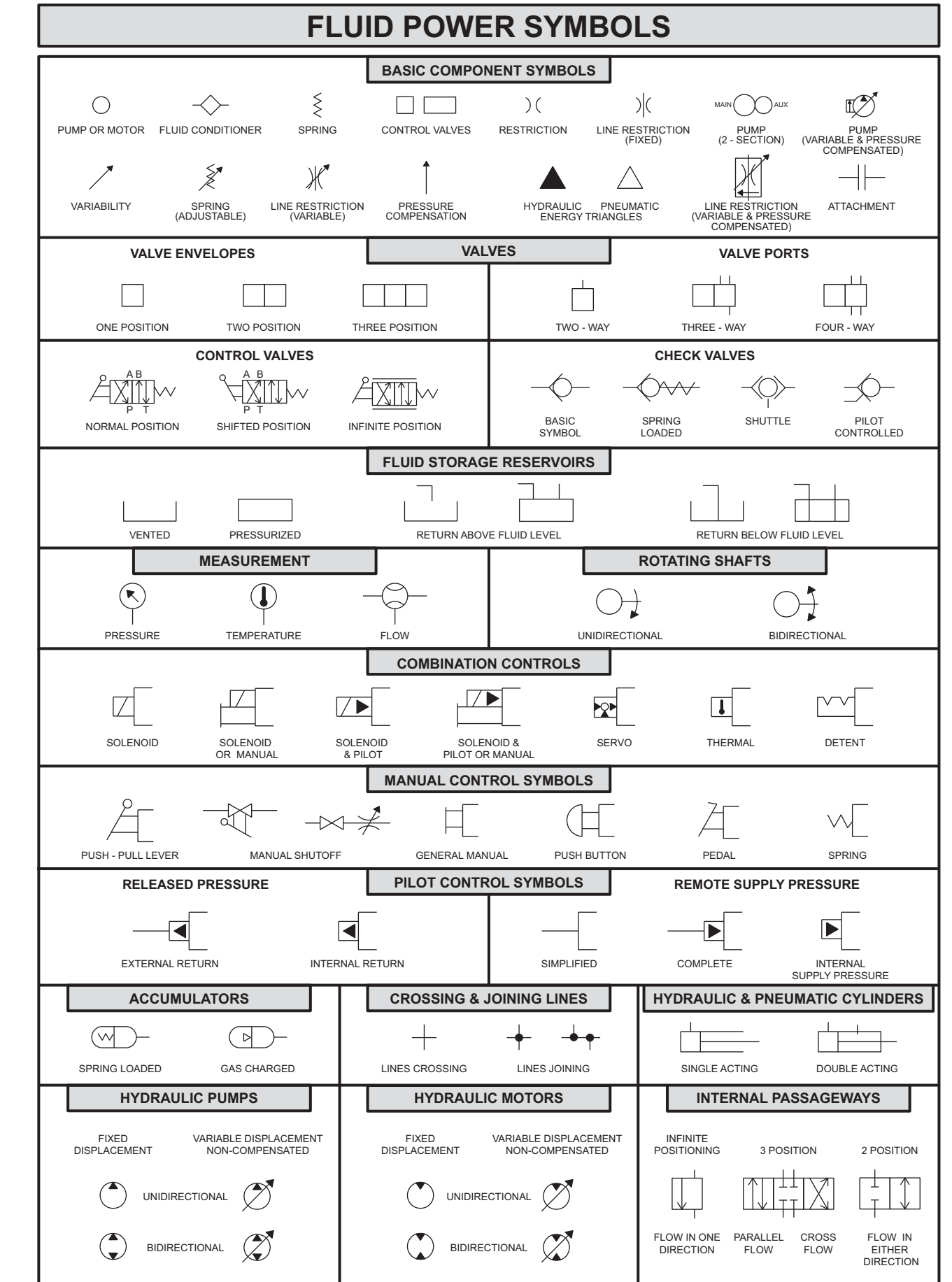

Component Location			
Description	Part Number	Machine Location	Schematic Location
Filter Gp - Front Charge Pump	302-7298	40	C-5
Filter Gp - Rear Charge Pump	302-7298	41	C-4
Manifold Gp - Control	357-3345	42	E-5
Motor Gp - AWD (LH Front)	354-0593	43	E-7
Motor Gp - AWD (RH Front)	354-0593	44	E-2
Pump Gp - AWD	332-1245	45	C-6
Valve Gp - Bypass	188-8726	46	C-2

Always check component part numbers with Parts Manual for your specific machine.

Tap Location Pressure and Sampling		
Tap Number	Description	Schematic Location
A1	LH AWD Motor Forward Pressure	E-5
A2	RH AWD Motor Reverse Pressure	E-5
B1	RH AWD Motor Forward Pressure	E-5
B2	LH AWD Motor Reverse Pressure	E-5
LL	Front Charge Pump Pressure	C-5
NN	Rear Charge Pump Pressure	C-4
PS1	RH Brake Pressure	E-5
PS2	LH Brake Pressure	D-5

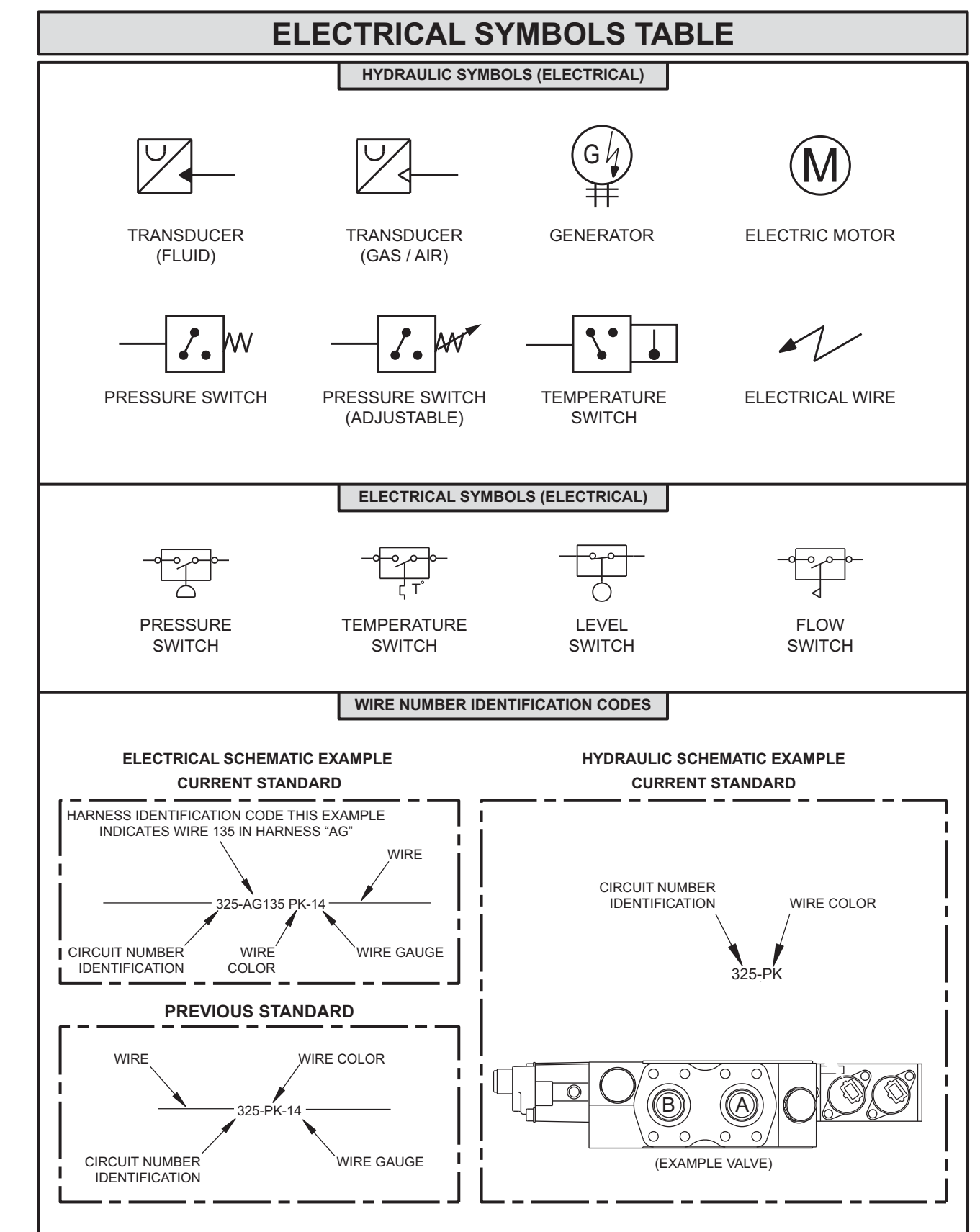

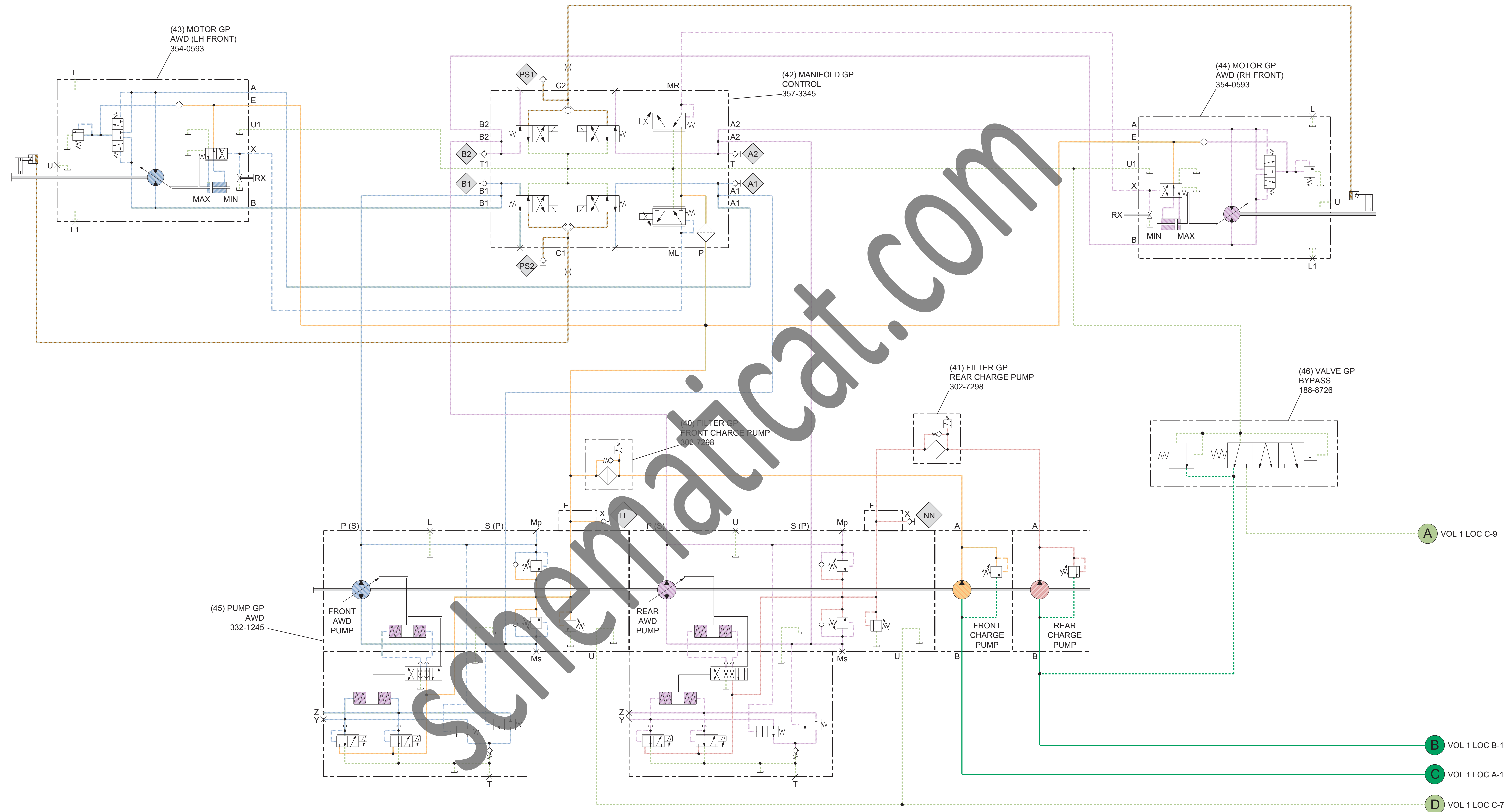

LINE PATTERNS	
	Pressure Line
	Pilot / Load Sensing Pressure
	Drain / Return Lines
	Component Group

CALLOUTS	
	Taps (Pressure, Sampling, Sensor, by letter)
	Callout Number: (52) VALVE GP - CONTROL
	Component Location (Letter)
	Part Number

HYDRAULIC CIRCUIT COLOR DESCRIPTIONS	
	SUPPLY LINE
	DRAIN / RETURN LINE
	FRONT WHEEL BRAKE CONTROL CIRCUIT
	FRONT CHARGE PUMP OUTPUT
	REAR CHARGE PUMP CIRCUIT
	REAR AWD PUMP AND RIGHT AWD MOTOR CONTROL CIRCUIT
	FRONT AWD PUMP AND LEFT AWD MOTOR CONTROL CIRCUIT

THIS SCHEMATIC IS FOR THE 12M, 120M, 140M AND 160M SERIES 2 MOTOR GRADER HYDRAULIC SYSTEM VOLUME 2 of 2: AWD
 MEDIA NUMBER: KENR9047-05
 SCHEMATIC PART NUMBER: 325-3830, CHANGE: 01, VERSION: -
 Components are shown installed on a fully operable machine with the key and engine off, transmission shifter in neutral and with parking brake set.
 Refer to the appropriate Service Manual for Troubleshooting, Specifications and Systems Operations.
 Note: Refer to the Parts Manual using a specific serial number prefix in SIS before ordering parts from this schematic.

- VOL 1 LOC C-9
- VOL 1 LOC B-12
- VOL 1 LOC A-12
- VOL 1 LOC C-7