

INTERACTIVE SCHEMATIC

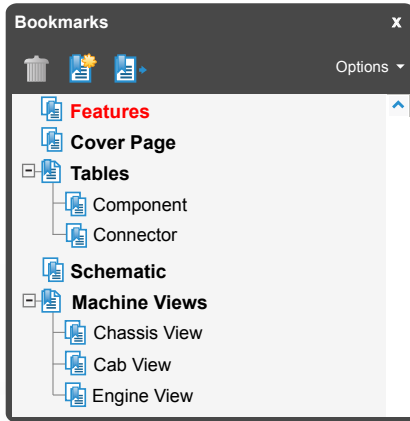

The Bookmarks panel will allow you to quickly navigate to points of interest.

****This document is best viewed at a screen resolution of 1024 X 768.***

To set your screen resolution do the following:
RIGHT CLICK on the **DESKTOP**.
 Select **PROPERTIES**.
CLICK the **SETTINGS TAB**.
MOVE THE SLIDER under **SCREEN RESOLUTION** until it shows **1024 X 768**.
CLICK OK to apply the resolution.

**Due to different monitor sizes and PDF reader preferences there may be some variance in linked schematic locations*

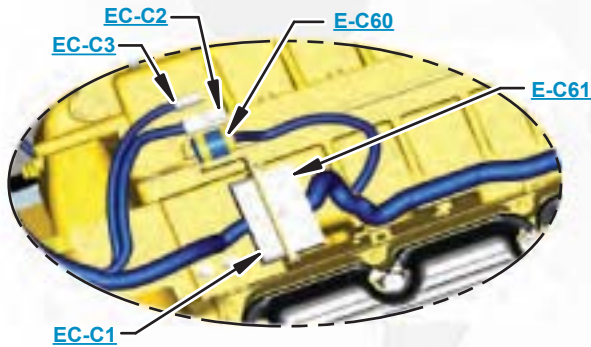

Click on any text that is **BLUE** and underlined. These are hyperlinks that can be used to navigate the schematic and machine views.



[Click here to save a copy of this interactive schematic to your desktop](#)

VIEW ALL CALLOUTS

When only one callout is showing on a machine view, clicking on this button will make all of the callouts visible. This button is located in the top right corner of every machine view page.

| HOTKEYS (Keyboard Shortcuts) | | |
|------------------------------|-------------|------------------------|
| | FUNCTION | KEYS |
| | Zoom In | “CTRL” / “+” |
| | Zoom Out | “CTRL” / “-” |
| | Fit to Page | “CTRL” / “0” (zero) |
| | Hand Tool | “SPACEBAR” (hold down) |
| | Find | “CTRL” / “F” |

| ELECTRICAL SYMBOLS | | | | |
|--------------------|--------------------|--------------|-------------|-----------------|
| | | | | |
| Pressure Switch | Temperature Switch | Level Switch | Flow Switch | Circuit Breaker |

| BASIC HYDRAULIC COMPONENT SYMBOLS | |
|-----------------------------------|---------------------|
| | |
| Pump or Motor | Variability |
| | |
| Fluid Conditioner | Spring (Adjustable) |

[Click here to view the Schematic Symbols and Definitions page](#)



SCHEMATIC SYMBOLS AND DEFINITIONS



| VALVES | | | |
|-----------------|------------------|-------------------|------------------|
| ENVELOPES | | | |
| | | | |
| One Position | Two Position | Three Position | |
| PORTS | | | |
| | | | |
| Two-way | Three-Way | Four-Way | |
| CONTROL | | | |
| | | | |
| Normal Position | Shifted Position | Infinite Position | |
| CHECK | | | |
| | | | |
| Basic Symbol | Spring Loaded | Shuttle | Pilot Controlled |

| INTERNAL PASSAGEWAYS | | | |
|-----------------------|----------------------------------|----------------|------------|
| | | | |
| Flow in One Direction | Flow Allowed in Either Direction | Parallel Flow | Cross Flow |
| | | | |
| Infinite Positioning | Two Position | Three Position | |

| PUMPS | |
|---------------------------------------|---------------|
| FIXED DISPLACEMENT | |
| | |
| Unidirectional | Bidirectional |
| VARIABLE DISPLACEMENT NON-COMPENSATED | |
| | |
| Unidirectional | Bidirectional |

| BASIC HYDRAULIC COMPONENT SYMBOLS | |
|--|---|
| | |
| Pump or Motor | Variability |
| | |
| Fluid Conditioner | Spring (Adjustable) |
| | |
| Spring | Pressure Compensation |
| | |
| Control Valves | Line Restriction (Variable) |
| | |
| Restriction | Line Restriction (Fixed) |
| | |
| Line Restriction Variable and Pressure Compensated | 2-Section Pump |
| | |
| Attachment | Pump: Variable and Pressure Compensated |
| | |
| Hydraulic Energy Triangles | Pneumatic Energy Triangles |

| CYLINDERS | |
|---------------|---------------|
| | |
| Single Acting | Double Acting |

| ACCUMULATORS | |
|---------------|-------------|
| | |
| Spring Loaded | Gas Charged |

| MOTORS | |
|---------------------------------------|---------------|
| FIXED DISPLACEMENT | |
| | |
| Unidirectional | Bidirectional |
| VARIABLE DISPLACEMENT NON-COMPENSATED | |
| | |
| Unidirectional | Bidirectional |

| ROTATING SHAFTS | |
|-----------------|---------------|
| | |
| Unidirectional | Bidirectional |

| PILOT CONTROL | | |
|------------------------|-----------------|--------------------------|
| RELEASED PRESSURE | | |
| | | |
| External Return | Internal Return | |
| REMOTE SUPPLY PRESSURE | | |
| | | |
| Simplified | Complete | Internal Supply Pressure |

| COMBINATION CONTROLS | | | | | | |
|----------------------|--------------------|--------------------|------------------------------|-------|---------|--------|
| | | | | | | |
| Solenoid | Solenoid or Manual | Solenoid and Pilot | Solenoid and Pilot or Manual | Servo | Thermal | Detent |

| LINES | |
|----------|---------|
| | |
| Crossing | Joining |

| MEASUREMENT | | |
|-------------|-------------|------|
| | | |
| Pressure | Temperature | Flow |

| MANUAL CONTROL | | | | | |
|-----------------|----------------|----------------|-------------|-------|--------|
| | | | | | |
| Push-pull Lever | Manual Shutoff | General Manual | Push Button | Pedal | Spring |

| FLUID STORAGE RESERVOIRS | | | |
|--------------------------|-------------|--------------------------|--------------------------|
| | | | |
| Vented | Pressurized | Return Above Fluid Level | Return Below Fluid Level |

| HYDRAULIC SYMBOLS - ELECTRICAL | | | | | | | |
|--------------------------------|------------------------|-----------|----------------|-----------------|------------------------------|--------------------|-----------------|
| | | | | | | | |
| Transducer (Fluid) | Transducer (Gas / Air) | Generator | Electric Motor | Pressure Switch | Pressure Switch (Adjustable) | Temperature Switch | Electrical Wire |

| ELECTRICAL SYMBOLS | | | | |
|--------------------|--------------------|--------------|-------------|-----------------|
| | | | | |
| Pressure Switch | Temperature Switch | Level Switch | Flow Switch | Circuit Breaker |

| BASIC ELECTRICAL COMPONENT SYMBOLS | |
|------------------------------------|---|
| | Fuse: A component in an electrical circuit that will open the circuit if too much current flows through it. |
| | Switch (Normally Open): A switch that will close at a specified point (temp, press, etc.). The circle indicates that the component has screw terminals and a wire can be disconnected from it. |
| | Switch (Normally Closed): A switch that will open at a specified point (temp, press, etc.). No circle indicates that the wire cannot be disconnected from the component. |
| | Ground (Wired): This indicates that the component is connected to a grounded wire. The grounded wire is fastened to the machine. |
| | Ground (Case): This indicates that the component does not have a wire connected to ground. It is grounded by being fastened to the machine. |
| | Reed Switch: A switch whose contacts are controlled by a magnet. A magnet closes the contacts of a normally open reed switch; it opens the contacts of a normally closed reed switch. |
| | Sender: A component that is used with a temperature or pressure gauge. The sender measures the temperature or pressure. Its resistance changes to give an indication to the gauge of the temperature or pressure. |
| | Relay (Magnetic Switch): A relay is an electrical component that is activated by electricity. It has a coil that makes an electromagnet when current flows through it. The electromagnet can open or close the switch part of the relay. |
| | Solenoid: A solenoid is an electrical component that is activated by electricity. It has a coil that makes an electromagnet when current flows through it. The electromagnet can open or close a valve or move a piece of metal that can do work. |
| | Magnetic Latch Solenoid: An electrical component that is activated by electricity and held latched by a permanent magnet. It has two coils (latch and unlatch) that make electromagnet when current flows through them. It also has an internal switch that places the latch coil circuit open at the time the coil latches. |

| HARNES AND WIRE SYMBOLS | |
|--|--|
| Wire, Cable, or Harness Assembly Identification: Includes Harness Identification Letters and Harness Connector Serialization Codes (see sample). | |
| | |
| Harness Identification Letter(s): (A, B, C, AA, AB, AC, ...) | |
| Harness Connector Serialization Code: The "C" stands for "Connector" and the number indicates which connector in the harness (C1, C2, C3, ...) | |
| | |
| Harness identification code: This example indicates wire group 325, wire 135 in harness "AG". | |
| | |
| Deutsch connector: Typical representation of a Deutsch connector. The plug contains all sockets and the receptacle contains all pins. | |
| Sure-Seal connector: Typical representation of a Sure-Seal connector. The plug and receptacle contain both pins and sockets. | |

Schematic

990K Wheel Loader 844K Wheel Dozer Hydraulic System

990K
DJK1-UP
A9P1-UP

844K
MBE1-UP
KLS1-UP

COMPONENT TABLE



| Component Locations | | | |
|---|-------------|----------------------------|--------------------|
| Description | Part Number | Schematic Location | Machine Location |
| Steering and Brake System - 990K / 844K | | | |
| Accumulator GP - Precharge (CE Certified) | 220-2718 | C-12, C-11 | 1 |
| Accumulator GP - Precharge (CE/CRN Certified) | 350-5572 | C-12, C-11 | 2 |
| Accumulator GP - Precharge (SELO Certified) | 455-1923 | C-12, C-11 | 3 |
| Accumulator GP - Precharge (Secondary Park Brake) | 424-7847 | B-11 | 4 |
| Brake GP - Parking | 294-7730 | D-8 | 5 |
| Control GP - Foot Brake | 305-5531 | C-9 | 6 |
| Cooler GP - Axle | 190-7625 | E-12 | 7 |
| Cylinder GP - Steering | 6E-1244 | E-16, E-15 | 8 |
| Filter GP - Oil | 295-6259 | D-12 | 9 |
| Filter GP - Screen | 328-8454 | A-13 | 10 |
| Manifold GP - Control | 273-8751 | C-11 | 11 |
| Pump GP - Axle Oil Cooling | 398-8976 | B-12 | 12 |
| Pump GP - Brake | 398-8977 | A-11 | 13 |
| Pump GP - Secondary Steering | 101-4007 | C-13 | 14 |
| Pump GP - Steering 844k | 395-0834 | B-14 | 15 |
| Pump GP - Steering 990k | 392-0758 | B-14 | 16 |
| Screen GP - Steering Pump Discharge | 288-5769 | C-14 | 17 |
| Sensor GP - Pressure (Brake Accum / Park Brake Oil) | 344-7391 | D-7 | 18 |
| Sensor GP - Axle Temp | 288-8390 | D-9, B-9 | 19 |
| Switch AS - Pressure | 327-4608 | B-7 | 20 |
| Tank GP - Hyd | 394-0244 | A-12 | 21 |
| Valve GP - Brake (Park Brake Override Attach) | 252-0742 | C-7 | 22 |
| Valve GP - Breaker | 358-9477 | B-12 | 23 |
| Valve GP - Check | 111-7775 | C-16 | 24 |
| Valve GP - Check | 123-4750 | B-15 | 25 |
| Valve GP - Check | 145-8983 | E-12 | 26 |
| Valve GP - Check | 123-4750 | B-11 | 27 |
| Valve GP - Check (Pilot Cushion) | 176-9369 | C-16 | 28 |
| Valve GP - Check (Pilot Override) | 176-9371 | D-16 | 29 |
| Valve GP - Check (Secondary Steering Load) | 7J-7423 | E-14 | 30 |
| Valve GP - Check (Steering Load) | 6E-3780 | D-14 | 31 |
| Valve GP - Control (Park Brake) | 349-4389 | C-8 | 32 |
| Valve GP - Diverter (Secondary Steering) | 2U-7345 | E-13 | 33 |
| Valve GP - Make Up | 4B-9782 | D-15 | 34 |
| Valve GP - Neutralizer | 296-5662 | C-16, C-15 | 35 |
| Valve GP - Pilot | 249-5615 | B-16 | 36 |
| Valve GP - Pilot (Steer W/Switch Protection) | 6E-3078 | C-14 | 37 |
| Valve GP - Pressure Reducing (Secondary Steering) | 6E-4286 | D-15 | 38 |
| Valve GP - Relief | 100-4335 | D-15 | 39 |
| Valve GP - Relief | 6E-3985 | E-16 | 40 |
| Valve GP - Relief | 224-5741 | D-12 | 41 |
| Valve GP - Relief (Brake Pump) | 234-0351 | B-12 | 42 |
| Valve GP - Relief (Secondary Steering) | 6E-3986 | E-13 | 43 |
| Valve GP - Secondary Steering (990k/844k Std) | 301-4608 | E-13 | 44 |
| Valve GP - Shuttle | 4T-1860 | E-15 | 45 |
| Valve GP - Shuttle (Park Brake Override Attach) | 8J-6875 | C-7 | 46 |
| Valve GP - Steering (990k Std) | 301-4605 | E-13 | 47 |
| Valve GP - Tandem Brake | 435-3890 | C-9 | 48 |

COMPONENT TABLE



Component Locations

| Description | Part Number | Schematic Location | Machine Location |
|--|-------------|---|--------------------|
| Axle Oil Cooling System - 990K / 844K | | | |
| Cooler GP - Axle Oil | 335-3449 | I-16 , H-12 | 49 |
| Filter GP - Screen | 230-3633 | I-13 , I-15 | 50 |
| Manifold GP - Relief | 257-5613 | H-15 | 51 |
| Pump / Motor GP - Axle Cooling | 340-2113 | H-13 | 52 |
| Valve GP - Check | 104-7108 | I-14 | 53 |
| Valve GP - Check | 124-5596 | I-12 | 54 |
| Valve GP - Diverter | 166-8497 | H-15 | 55 |
| Valve GP - Solenoid | 329-5064 | H-15 | 56 |
| Valve GP - Sequencing | 440-9695 | H-15 | 57 |

COMPONENT TABLE



| Component Locations | | | |
|--|-------------|--|---------------------|
| Description | Part Number | Schematic Location | Machine Location |
| Implement / Fan System - 990K | | | |
| Accumulator GP - Precharge | 450-0392 | H-1 | 58 |
| Accumulator GP - Precharge | 245-2975 | F-5 | 59 |
| Actuator GP | 217-6720 | H-5, H-4, H-3 | 60 |
| Actuator GP | 217-6719 | H-5, H-4, H-3 | 61 |
| Cooler AS - Air To Oil | 261-3853 | D-5 | 62 |
| Cyl GP - Lift (High Lift) (Not Shown) | 351-8446 | J-5, J-2 | 63 |
| Cyl GP - Lift (Logger Attach) (Not Shown) | 262-3668 | J-5, J-2 | 64 |
| Cyl GP - Lift (Standard) | 394-4402 | J-5, J-2 | 65 |
| Cyl GP - Tilt (High Lift) (Not Shown) | 420-5536 | J-4 | 66 |
| Cyl GP - Tilt (Logger Attach) (Not Shown) | 423-9727 | J-4 | 67 |
| Cyl GP - Tilt (Standard) | 417-0818 | J-4 | 68 |
| Filter GP - Element | 4T-3134 | C-4 | 69 |
| Filter GP - Oil | 328-8454 | D-4 | 70 |
| Filter GP - Oil | 295-6259 | D-5 | 71 |
| Motor GP - Fan | 159-7166 | E-5 | 72 |
| Orifice (Not Shown) | 384-5447 | D-5 | 73 |
| Plug | 1T-0936 | G-1 | 74 |
| Pump GP - Fan | 392-0757 | E-3 | 75 |
| Pump GP - Impl (Double) | 398-8229 | D-2 | 76 |
| Screen - Hydraulic | 380-8484 | D-5, C-5 | 77 |
| Screen AS | 9T-9227 | C-5 | 78 |
| Screen GP (Not Shown) | 172-2395 | D-2 | 79 |
| Screw - Bleeder | 9F-2167 | H-1, J-3, J-4 | 80 |
| Tank GP - Hyd | 394-0234 | C-5 | 81 |
| Valve - Check | 9T-1013 | G-6 | 82 |
| Valve - Check (Float) | 6E-1291 | H-5 | 83 |
| Valve - Manual Lower | 112-1817 | G-5 | 84 |
| Valve AS - Breaker | 358-9477 | D-4 | 85 |
| Valve GP - Check | 4T-5896 | I-6 | 86 |
| Valve GP - Check | 123-4750 | F-5 | 87 |
| Valve GP - Check | 201-7651 | G-1 | 88 |
| Valve GP - Check | 353-2313 | D-5 | 89 |
| Valve GP - Check (load) | 102-4156 | H-3, H-4 | 90 |
| Valve GP - Control | 366-8212 | J-6 | 91 |
| Valve GP - Control (Logger / 3rd Function) (Not Shown) | 366-8213 | J-6 | 92 |
| Valve GP - Dead Engine Lower | 370-0438 | I-6 | 93 |
| Valve GP - Makeup | 193-0629 | E-5 | 94 |
| Valve GP - Relief | 425-6958 | H-3 | 95 |
| Valve GP - Relief | 367-8969 | F-5 | 96 |
| Valve GP - Relief (Aux Line) (Not Shown) | 423-7705 | I-4 | 97 |
| Valve GP - Relief (Aux Line) (Not Shown) | 423-7705 | I-3 | 98 |
| Valve GP - Relief (Lift Rod End / Tilt Head End) | 423-7707 | I-4 | 99 |
| Valve GP - Relief (Lift, Head End) | 423-7709 | H-5 | 100 |
| Valve GP - Relief (Tilt, Rod End) | 165-2488 | I-4 | 101 |
| Valve GP - Ride Control (Attach) | 452-4868 | G-2 | 102 |
| Valve GP - Shuttle | 4T-1860 | I-5 | 103 |
| Valve GP - Solenoid (Implement Pilot Supply) | 396-1209 | H-6 | 104 |
| Valve GP - Solenoid (Lift Float) | 147-1223 | G-5 | 105 |
| Valve GP - Solenoid (Ride Control Activation) | 352-2734 | H-2 | 106 |
| Valve GP - Solenoid (Ride Control Bal Spool) | 397-9397 | G-2 | 107 |

COMPONENT TABLE



| Component Locations | | | |
|---|-------------|--------------------------|---------------------|
| Description | Part Number | Schematic Location | Machine Location |
| Implement / Fan System - 844K | | | |
| Accumulator GP | 245-2975 | J-9 | 106 |
| Connector - Orifice | 260-9227 | J-8 | 107 |
| Connector - Orifice | 315-5865 | J-10 | 108 |
| Cooler AS - Impl | 261-3853 | H-12 | 109 |
| Cyl GP - Lift | 390-6321 | H-7 | 110 |
| Cyl GP - Tilt | 109-8832 | H-7 | 111 |
| Cyl GP - Tilt | 109-8833 | I-7 | 112 |
| Filter GP - Fan Pump / Motor | 328-8454 | G-11 | 113 |
| Filter GP - Hyd Oil | 4T-3134 | F-9 | 114 |
| Filter GP - Implement Pilot Oil | 295-6259 | I-11 | 115 |
| Manifold GP - Eh Pilot Controls | 332-1115 | J-9 | 116 |
| Motor GP - Fan | 159-7166 | H-11 | 117 |
| Pump GP - Fan | 392-0757 | G-10 | 118 |
| Pump GP - Implement | 157-0956 | G-8 | 119 |
| Screen - Hyd Oil | 380-8484 | F-9, F-8 | 120 |
| Screen AS | 9T-9227 | F-9 | 121 |
| Tank GP - Hyd | 394-0234 | F-8 | 122 |
| Valve - Check (Load) | 9T-3746 | H-9 | 123 |
| Valve - Makeup | 6E-4343 | H-8 | 124 |
| Valve - Manual Lower | 112-1817 | G-8 | 125 |
| Valve - Relief Poppet | 6J-2561 | I-9 | 126 |
| Valve AS - Breaker | 358-9475 | G-9 | 127 |
| Valve GP - Check | 353-2313 | H-11 | 128 |
| Valve GP - Check | 177-3868 | I-9 | 129 |
| Valve GP - Check (Tilt) | 9T-3746 | H-10 | 130 |
| Valve GP - Control (Dozer) | 394-8535 | H-10 | 131 |
| Valve GP - Control (Dual Tilt) | 225-2321 | I-8 | 132 |
| Valve GP - Lift (Unloading) | 3G-1201 | H-10 | 133 |
| Valve GP - Lift System | 241-8833 | H-9 | 134 |
| Valve GP - Makeup | 193-0629 | H-11 | 135 |
| Valve GP - Pressure Relief | 252-8038 | I-9 | 136 |
| Valve GP - Relief Poppet | 6J-2561 | H-10 | 137 |
| Valve GP - Shuttle | 8J-7430 | G-10 | 138 |
| Valve GP - Shuttle | 249-7805 | G-7 | 139 |
| Valve GP - Shuttle (Ball Resolver) | 4T-4073 | G-9 | 140 |
| Valve GP - Solenoid | 3E-9205 | I-8 | 141 |
| Valve GP - Solenoid (Impl Controls) | 111-9916 | J-9 | 142 |
| Valve GP - Solenoid (Impl Pilot Supply) | 233-7126 | J-9 | 143 |
| Valve GP - Tilt | 1U-0368 | H-10 | 144 |
| Valve GP - Tilt (Unloading) | 9J-4794 | H-9 | 145 |

COMPONENT TABLE



Component Locations

| Description | Part Number | Schematic Location | Machine Location |
|--|-------------|----------------------|---------------------|
| 990K / 844K Additional Pressure Sensors | | | |
| Sensor GP - Steering Tank Oil Press (844/990) | 288-8390 | A-12 | 146 |
| Sensor GP - Brake Accum Press (844/990) | 344-7391 | B-11 | 147 |
| Sensor GP - Impl Pilot Oil Press (844) | 344-7389 | J-8 | 148 |
| Sensor GP - Demand Fan Oil Press (844) | 344-7391 | H-11 | 149 |
| Sensor GP - Impl Tank Oil Temp (844) | 256-6453 | F-8 | 150 |
| Sensor GP - Impl Fixed Pump Oil Press (844) | 349-1178 | G-8 | 151 |
| Sensor GP - Lift Cyl Press (990) | 237-0227 | J-5 | 152 |
| Sensor GP - Impl Pilot Oil Press (990) | 344-7389 | F-6 | 153 |
| Sensor GP - Impl Tank Oil Temp (990) | 256-6457 | C-4 | 154 |
| Sensor GP - Impl Pump Oil Press (990) | 349-1178 | D-2 | 155 |
| Sensor GP - Demand Fan Oil Press (990) | 344-7391 | E-5 | 156 |

| Tap Locations Pressure, Sampling, and Sensor | | |
|---|----------------------------------|-------------------------------|
| Tap Number | Description | Schematic Location |
| 990K / 844K Steering and Brake Taps | | |
| SB1 | Steering Cylinder Pressure | E-16 |
| SB2 | Steering Cylinder Pressure | E-16 |
| SB3 | Secondary steering Pump Pressure | D-1 |
| SB4 | Steering Supply Pilot Pressure | B-1 |
| SB5 | Steering Pump Pilot Pressure | A-16 |
| SB6 | Steering Pump Pressure | B-14 |
| SB7 | SOS Oil Sampling | D-13 |
| SB8 | Axle Oil Return Pressure | B-13 |
| SB9 | Axle Oil Pump Pressure | B-12 |
| SB10 | Rear Brake Supply Pressure | C-12 |
| SB11 | Front Brake Supply Pressure | C-11 |
| SB12 | Service Brake Pressure Front | D-10 |
| SB13 | Service Brake Pressure Rear | B-10 |
| 990K Implement / Fan System Taps | | |
| AA | Lift Head End Pressure | J-5 |
| BB | Lift Rod End Pressure | J-5 |
| CC | 3rd Function Pressure | J-4 |
| DD | 3rd Function Pressure | J-3 |
| EE | Impl Pilot Supply Pressure | F-5 |
| FF | Fan Pump Discharge Pressure | F-4 |
| GG | Impl Pump Pressure | D-4 |
| HH | Impl Pump Pressure | D-2 |
| JJ | Fan Motor Return Pressure | D-5 |
| 844K Implement / Fan System Taps | | |
| KK | Tilt Pilot Pressure | J-10 |
| LL | Tilt Pilot Pressure | J-8 |
| NN | Lift Pilot Pressure | J-10 |
| PP | Lift Pilot Pressure | J-8 |
| RR | Fan Pump Discharge Pressure | G-11 |
| SS | Fan Return Oil Pressure | G-11 |
| TT | Impl Pump Pressure | G-8 |
| UU | Impl Pump Pressure | G-8 |
| YY | Fan Motor Return Pressure | G-10 |

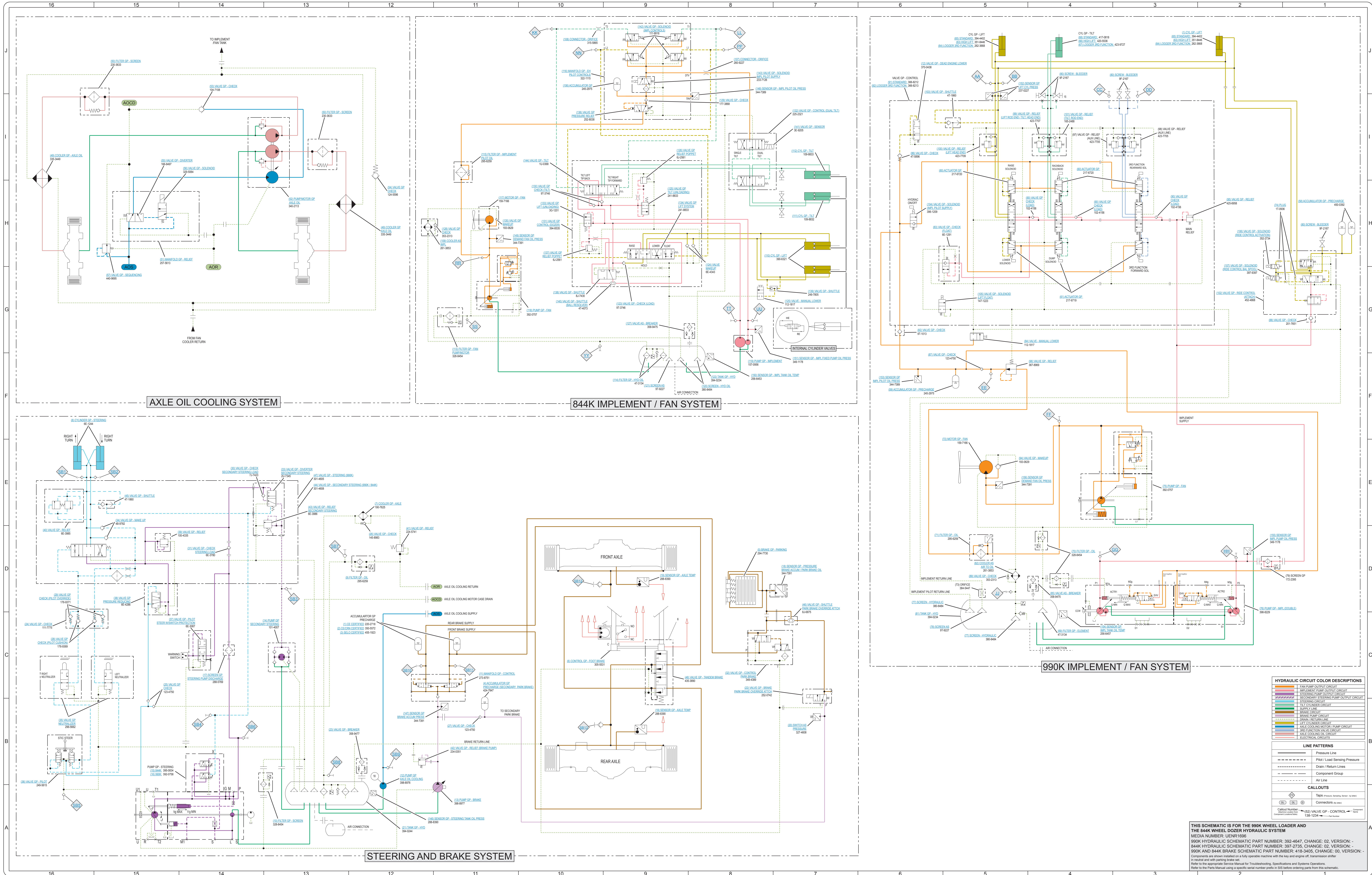

THIS SCHEMATIC IS FOR THE 844K WHEEL LOADER AND THE 844K WHEEL DOZER HYDRAULIC SYSTEM
 MEDIA NUMBER: UENR1696
 844K HYDRAULIC SCHEMATIC PART NUMBER: 392-4647, CHANGE: 02, VERSION: -
 844K HYDRAULIC SCHEMATIC PART NUMBER: 397-2735, CHANGE: 02, VERSION: -
 844K HYDRAULIC SCHEMATIC PART NUMBER: 418-3405, CHANGE: 00, VERSION: -
 Components are shown installed on a fully equipped machine with the key and engine off. Connections are in neutral and with parking brake set.
 Refer to the appropriate Service Manual for Troubleshooting, Specifications and Systems Operations.
 Refer to the Parts Manual using a specific serial number prefix in S&S before ordering parts from this schematic.

990K STD IMPL VALVE

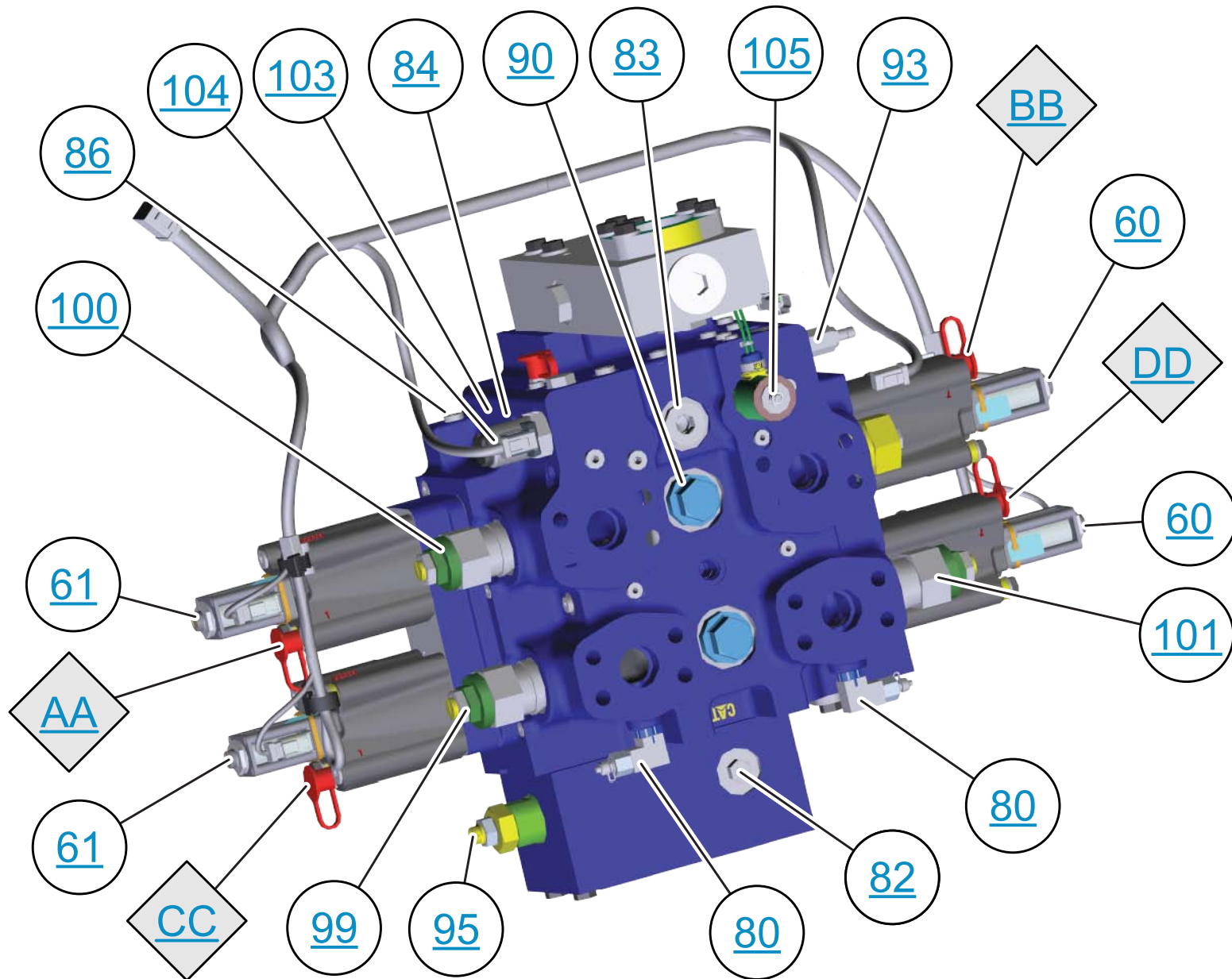

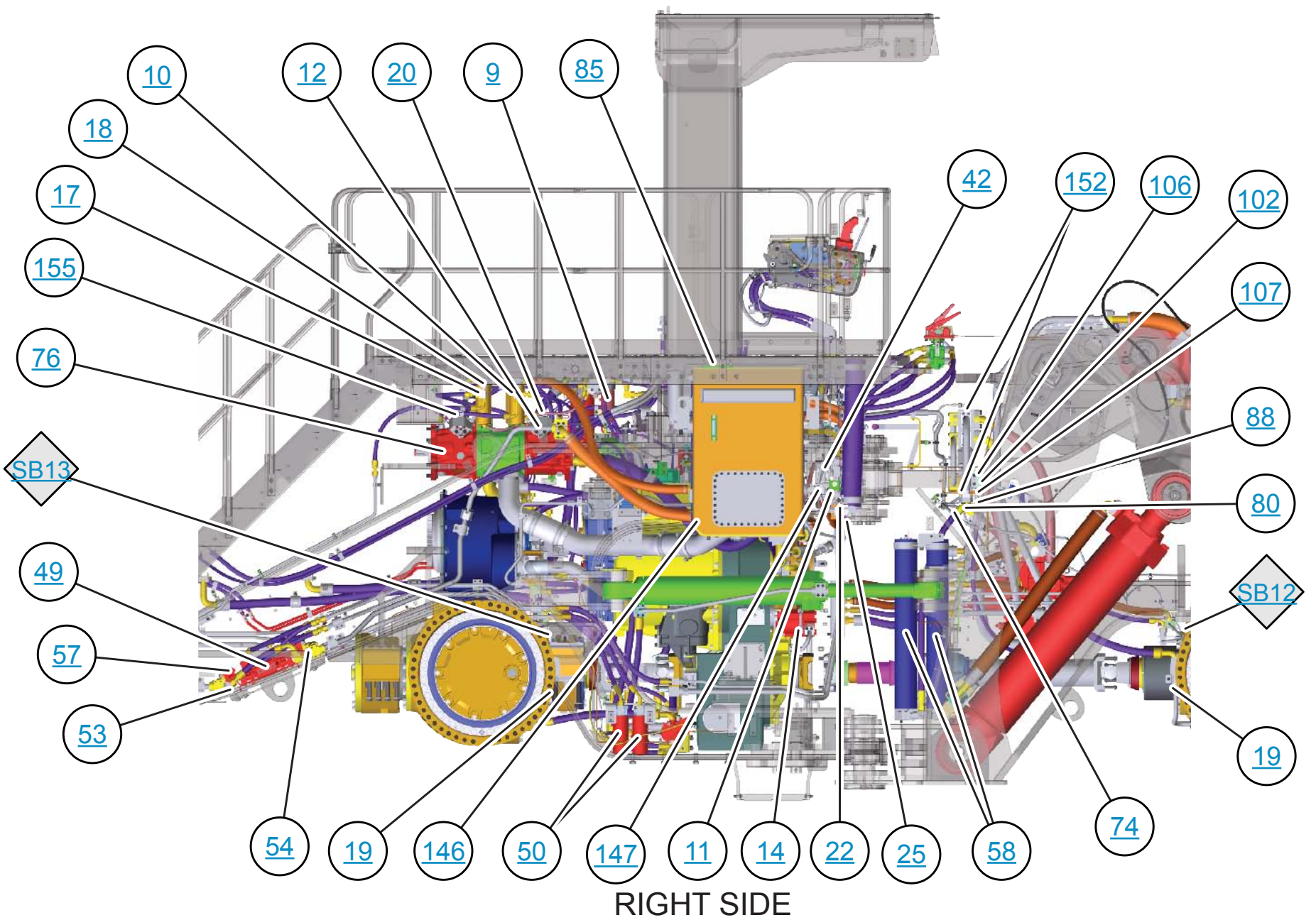
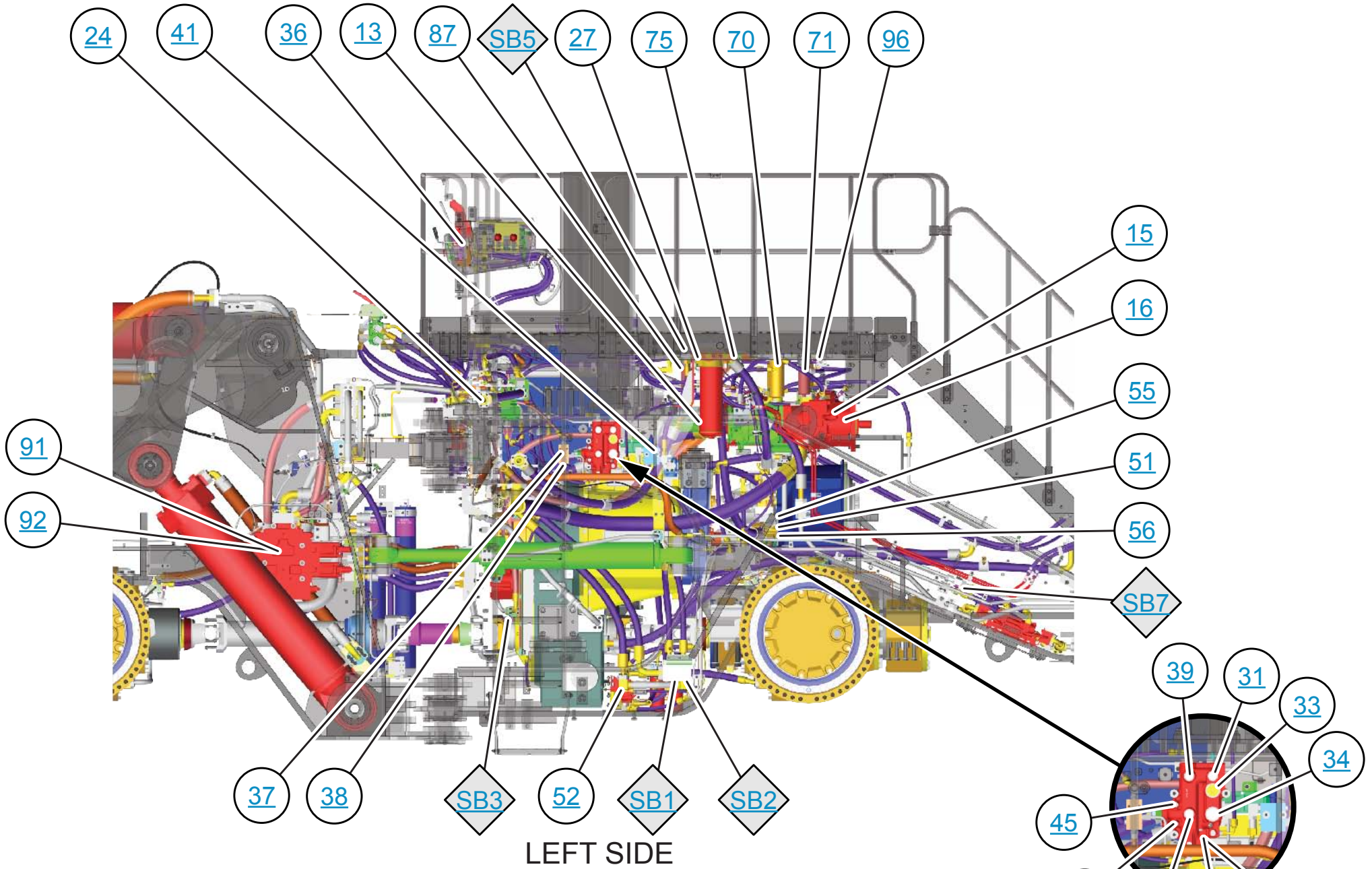

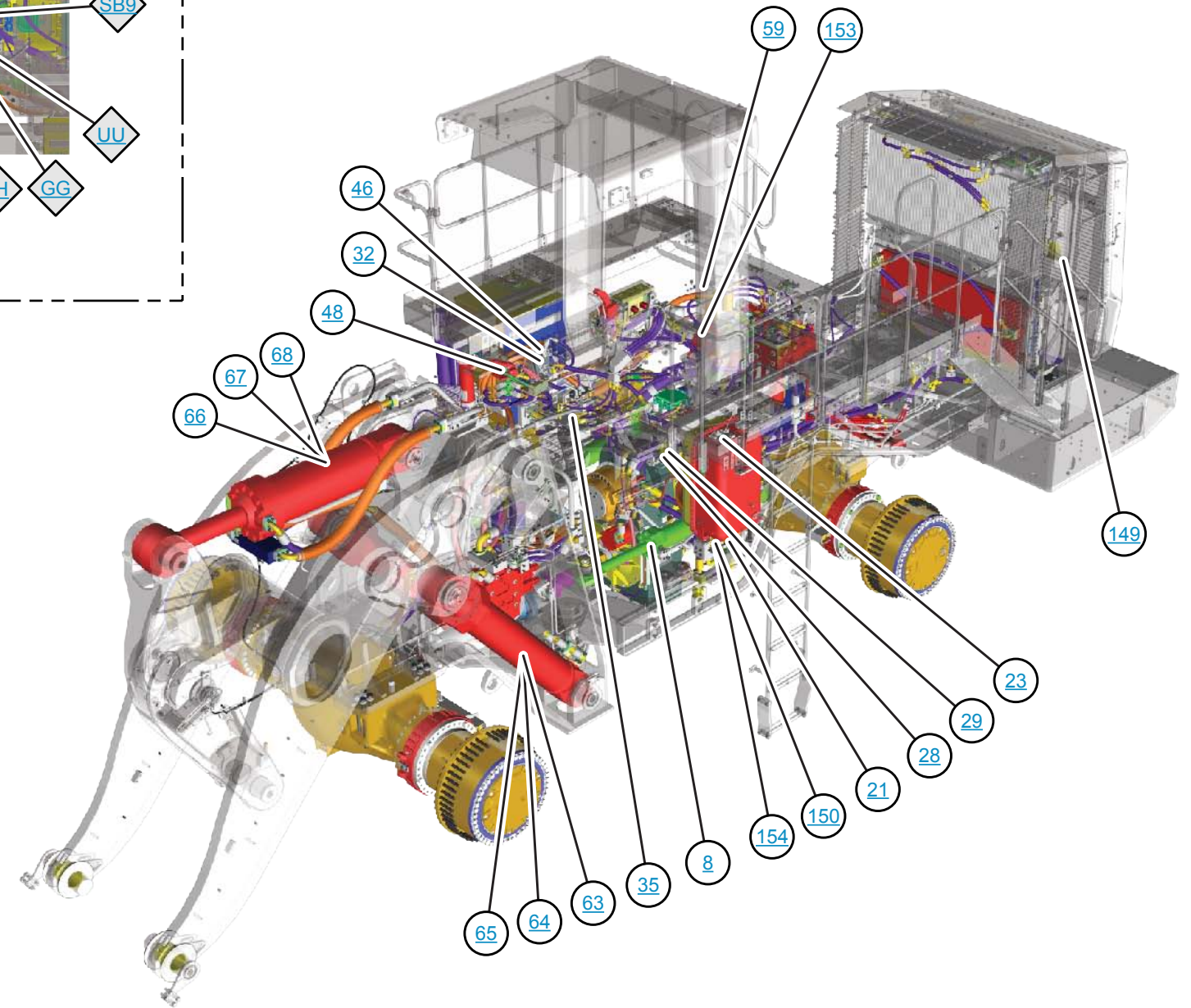
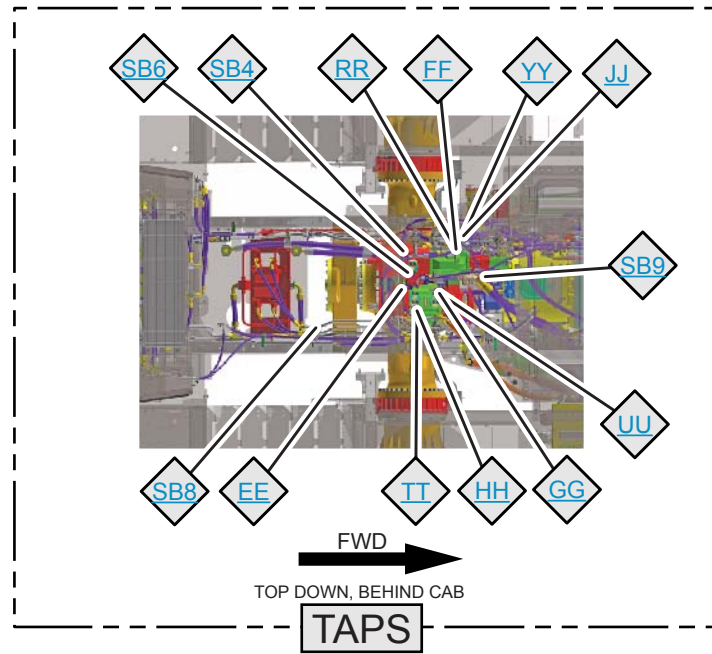
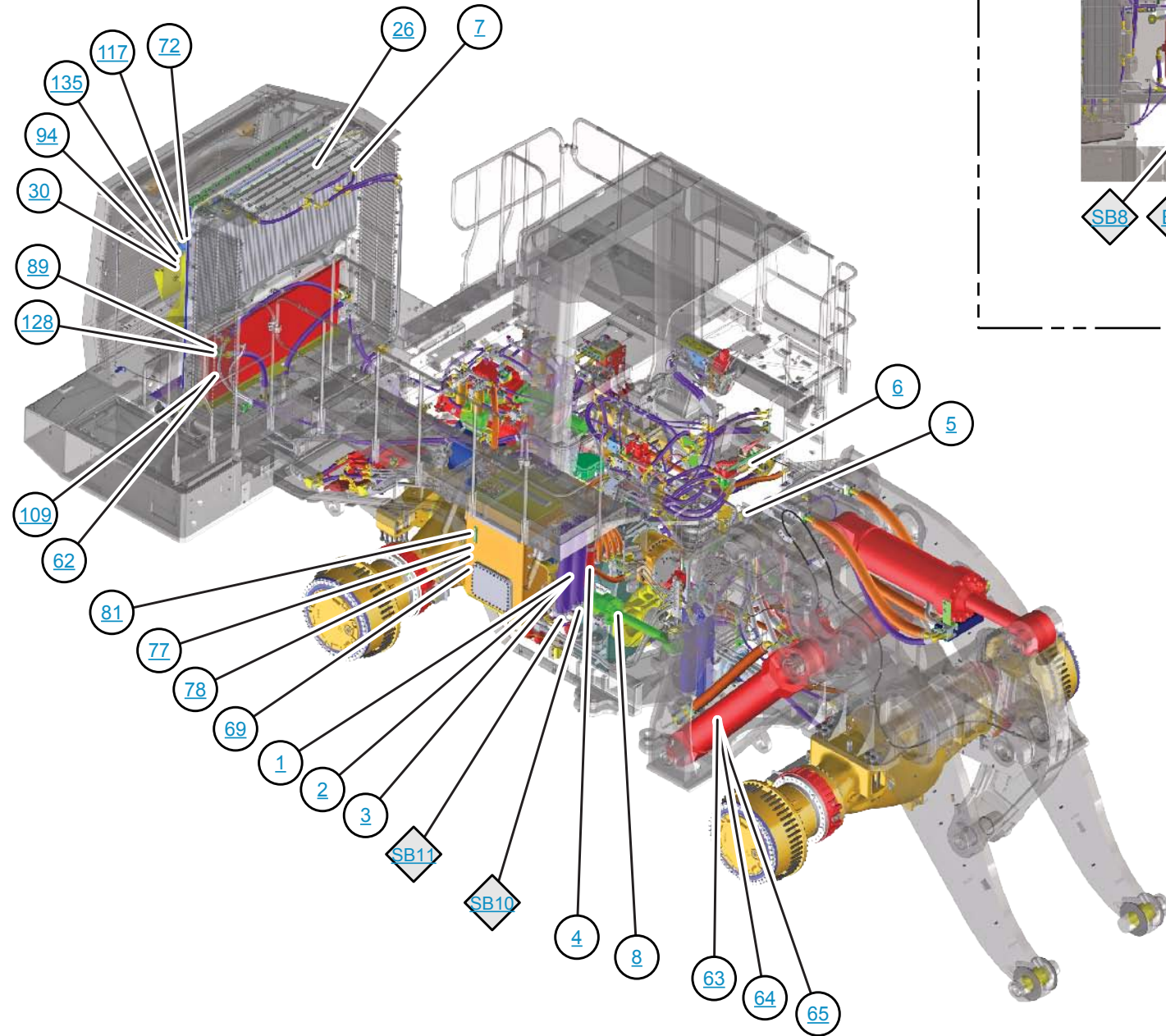

844K STD IMPL VALVE

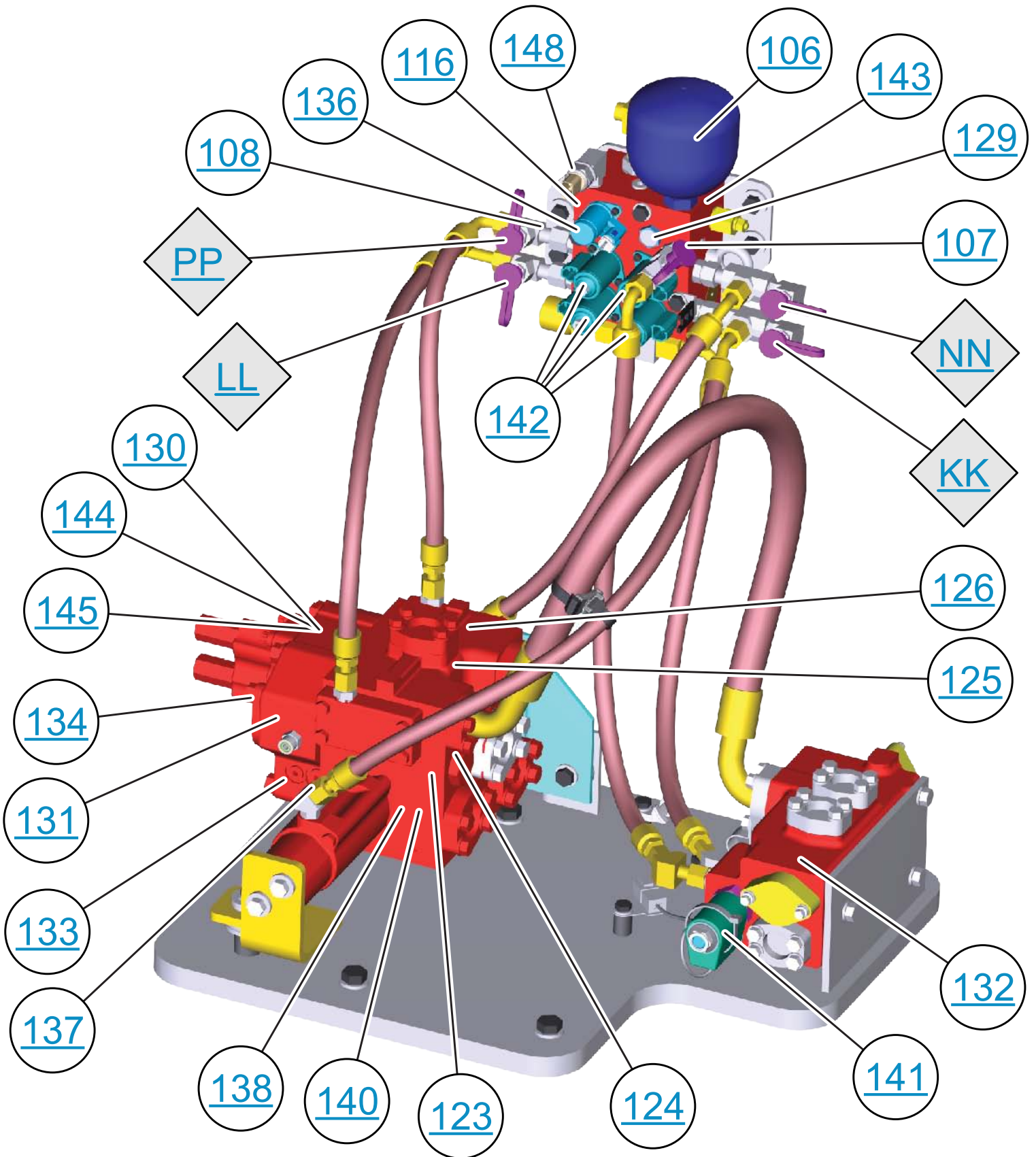

844K FRONT VIEW

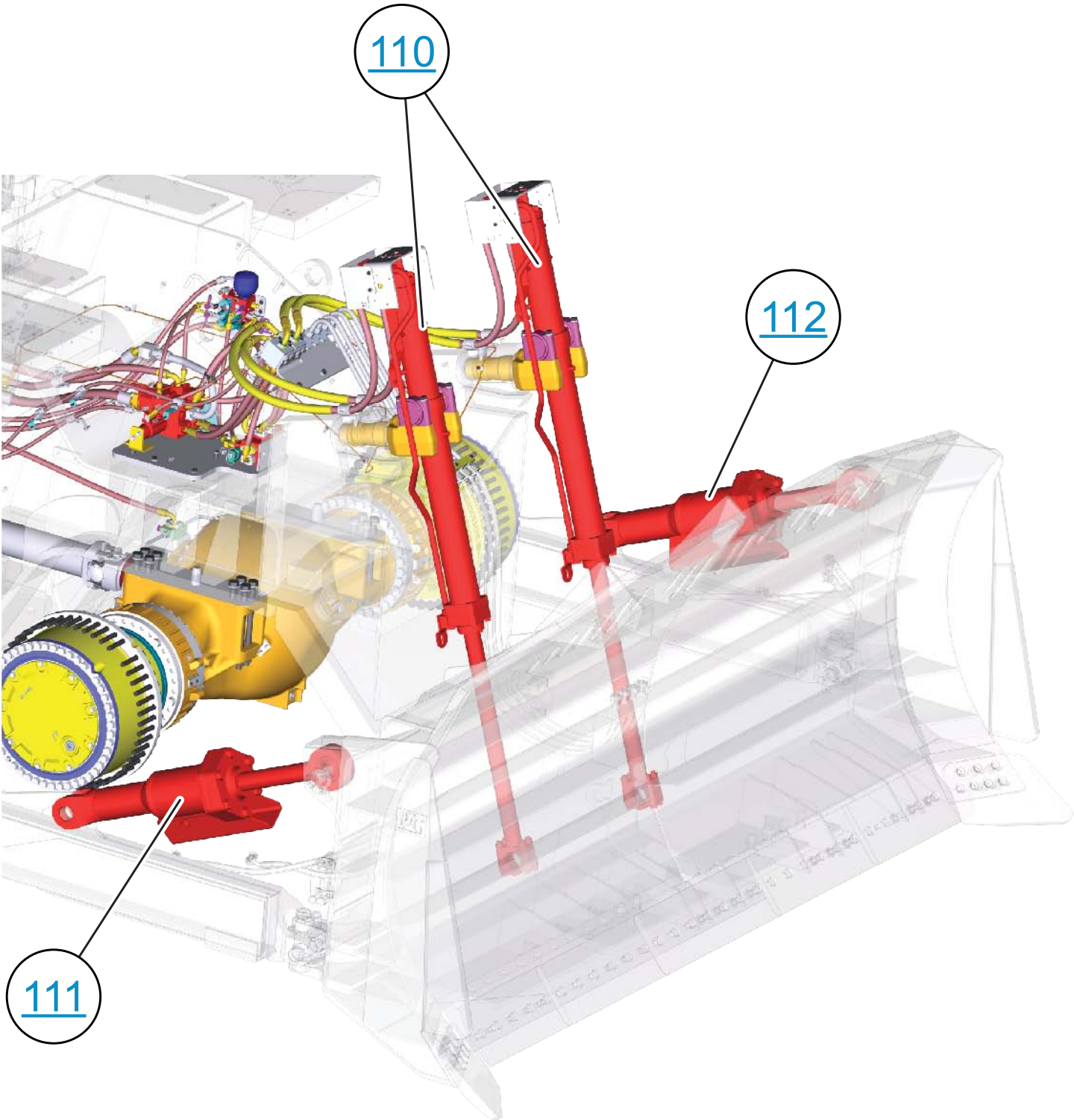

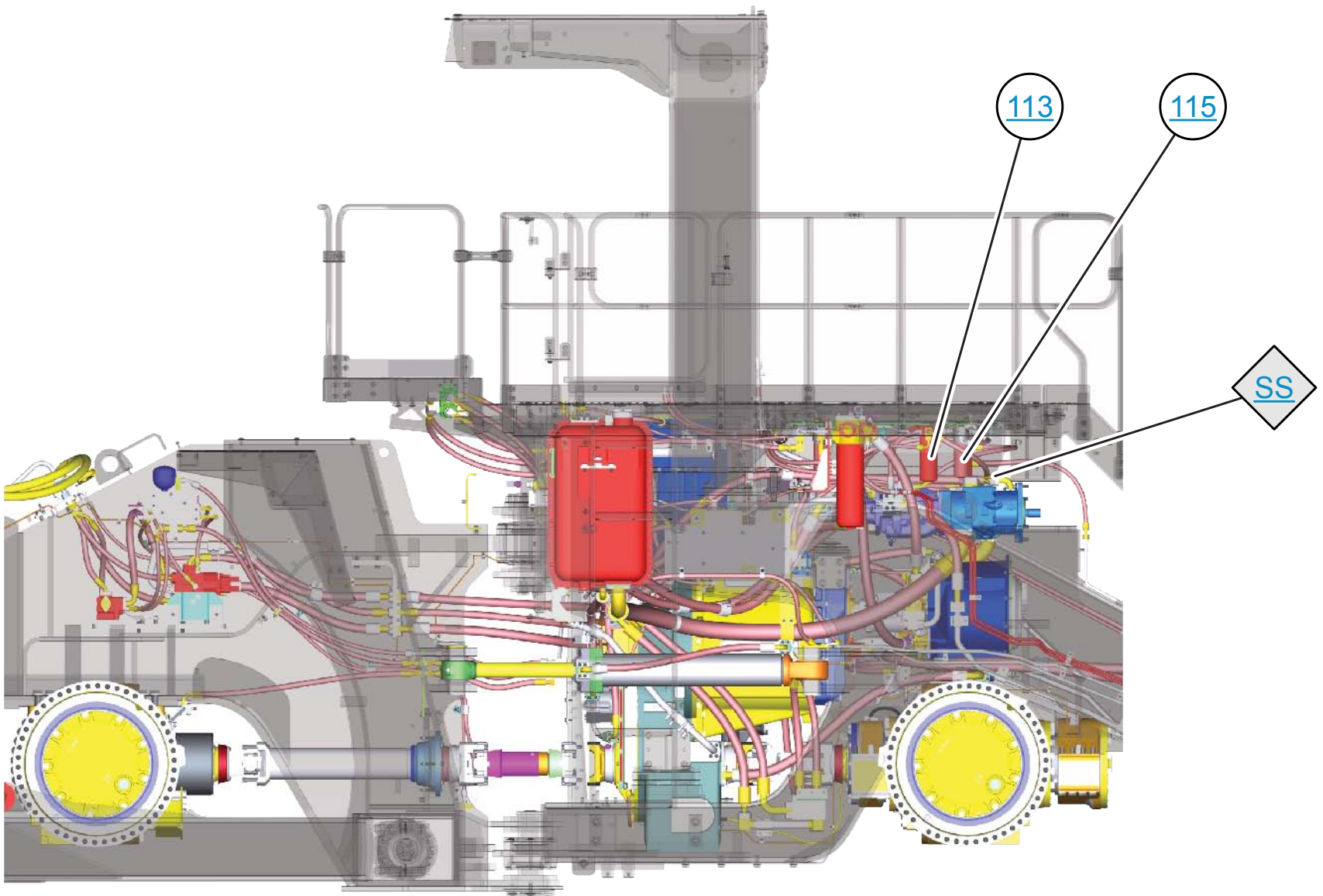

LEFT SIDE

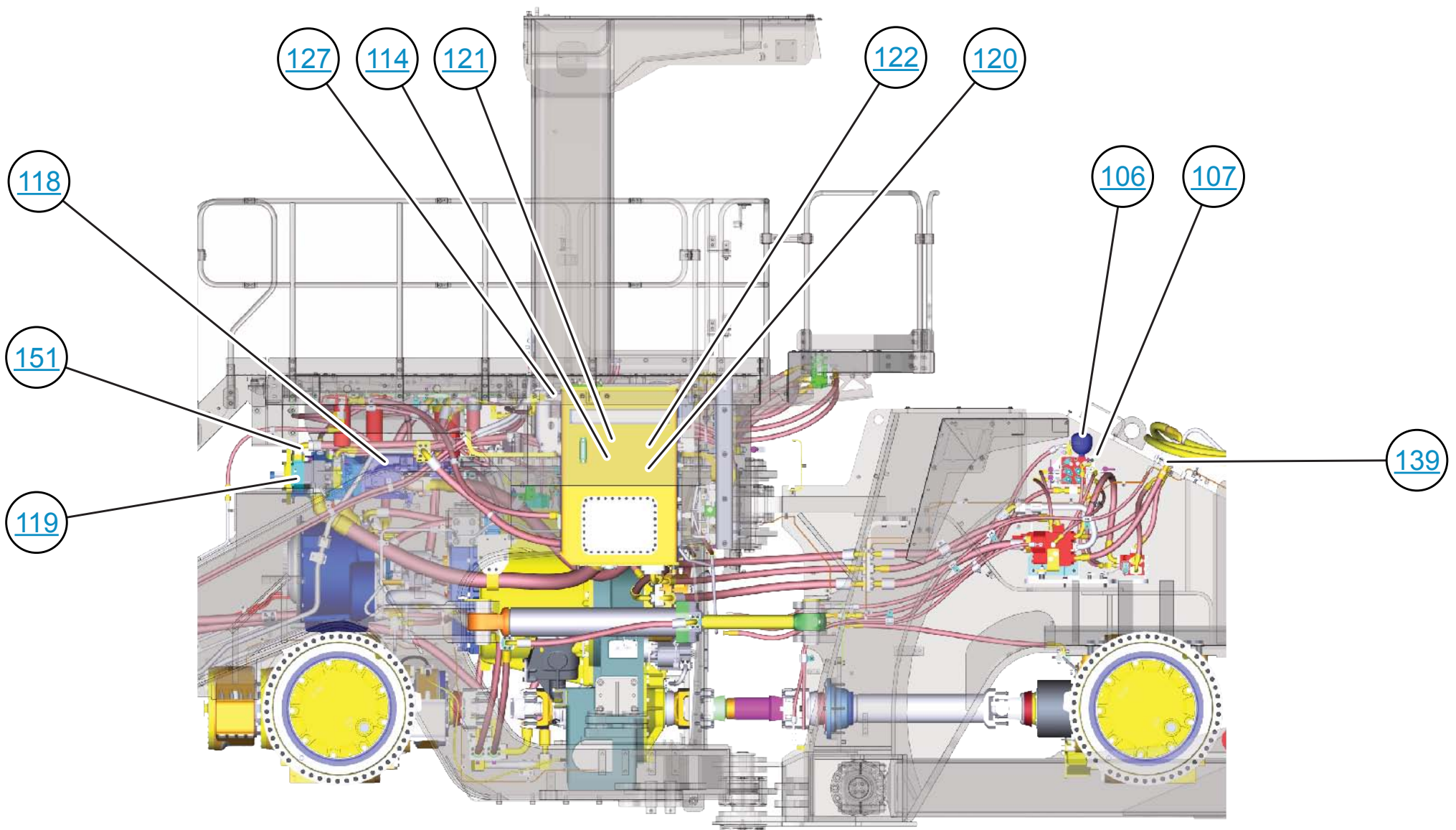

RIGHT SIDE