

Component Locations			
Description	Part Number	Machine Location	Schematic Location
STANDARD			
Accumulator - Pre Charge	200-0750	1	C-3
Cooler As.	373-6407	2	A-11
Cover - Pump 1 End	384-7475	3	D-3
Cover - Pump 1 End	377-3686	4	G-14
Cylinder Gp - Lift	372-4283	5	I-11
Cylinder Gp - Tilt	374-2278	6	I-13
Cylinder Gp - Tilt	374-2279	7	I-8
Filter Gp - Oil	341-1330	8	D-11
Manifold Gp - Center	420-4712	9	G-9
Motor Gp - Fan	373-6632	10	B-12
Pump Gp - Fan	373-6631	11	B-10
Pump Gp - Implement Pump 1	373-6629	12	C-8
Pump Gp - Implement Pump 2	373-6630	13	C-6
Pump Gp - Variable Charge	289-4027	14	B-9
Tank Gp - Hydraulic Oil	374-7146	15	B-3
Valve As. - Control	384-8436	16	A-11, A-8
Valve Gp - Check	193-9230	17	A-8
Valve Gp - Check Impl Return Back Press	353-7179	18	D-8
Valve Gp - Bypass Thermal Relief	417-4160	19	A-8
Valve Gp - Implement	377-3673	20	G-8
Valve Gp - Lift	377-3674	21	G-13, G-4
Valve Gp - Pilot Implement Lockout	341-9000	22	D-4
Valve Gp - Ripperper Lift	377-3676	23	G-7
Valve Gp - Ripperper Shank	377-3677	24	G-10
Valve Gp - Tilt	377-3675	25	G-12, G-6
Valve - Vacuum Breaker	358-9566	26	C-4
RipperPER ATTACHMENT			
Cylinder Gp - Ripper Lh Lift	374-2276	27	I-5
Cylinder Gp - Ripper Rh Lift	374-2277	28	I-6
Cylinder Gp - Ripper Shank	374-2285	29	I-7, I-4
PIN PULLER OPTION			
Cylinder Gp - Ripper Pin Pull	8E-3113	30	F-3
Valve Gp - Pin Puller Valve	188-6140	31	F-2
LADDER OPTION			
Actuator Gp - Ladder	379-8927	32	I-2
Pump Gp - Ladder	379-6545	33	G-2
AUTOCARRY OPTION			
Cylinder Gp - Lift Cylinder With Position Sensing	374-6601	34	I-9
PRESSURE VESSEL REGULATIONS ATTACHMENT			
Valve Gp - Vacuum Breaker	358-9477	35	C-4
Reservoir - Expansion Tank	221-5500	36	B-4
SINGLE TILT OPTION			
Valve Gp - Implement Valve (Item 5B Removed)	1415-9402	37	G-8
REFERENCE SENSORS AND SWITCHES			
Sensor Gp - Implement Pressure	286-5270	38	G-9
Sensor Gp - Temp Hydraulic	145-7028	39	B-3
Switch As. - Filter Bypass	227-6744	40	C-11
Switch As. - Filter Bypass	253-2673	41	A-4

Tap Locations Pressure, Sampling, and Sensor		
Tap Number	Description	Schematic Location
AP	Accumulator Pressure	D-4
HA	Impl-pump-discharge	G-9
HB	Impl-pump-signal	D-7
F	Charge Pump Press Outlet	D-10
HPS	Pilot Supply	D-4
FX1	Fan Pilot Pressure X1	B-11
FX2	Fan Pilot Pressure X2	B-11
FMA	Fan Loop Pressure Ma	C-12
FMB	Fan Loop Pressure Mb	B-12
FMC	Fan Motor Case (B)	A-13
LC1	Ladder Lower Pressure	H-3
LC2	Ladder Raise Pressure	H-2
LA1	Ladder Actuator Purge A1	I-3
LA2	Ladder Actuator Purge A2	I-2

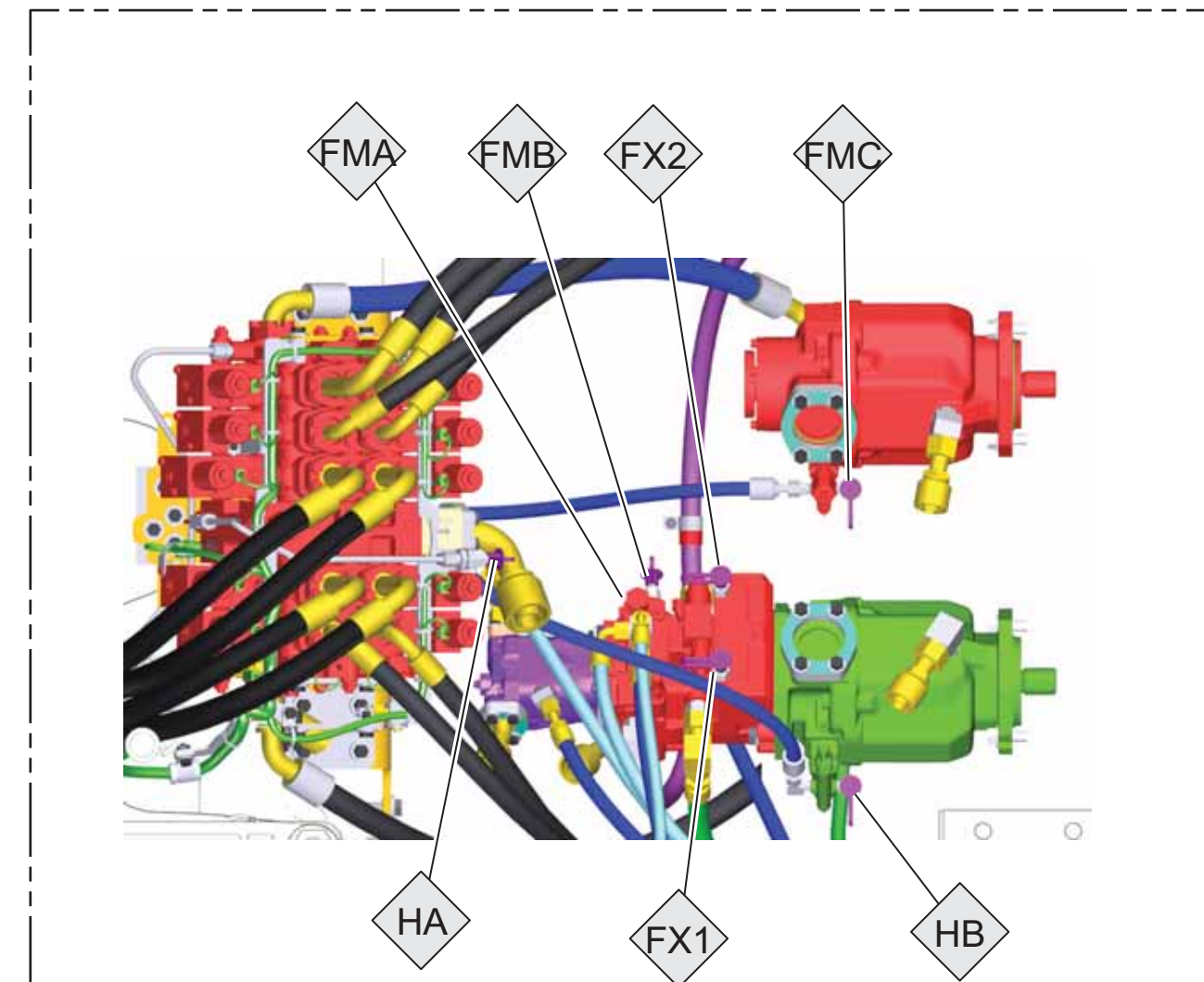

TAPS: MACHINE VIEW (TOP DOWN)

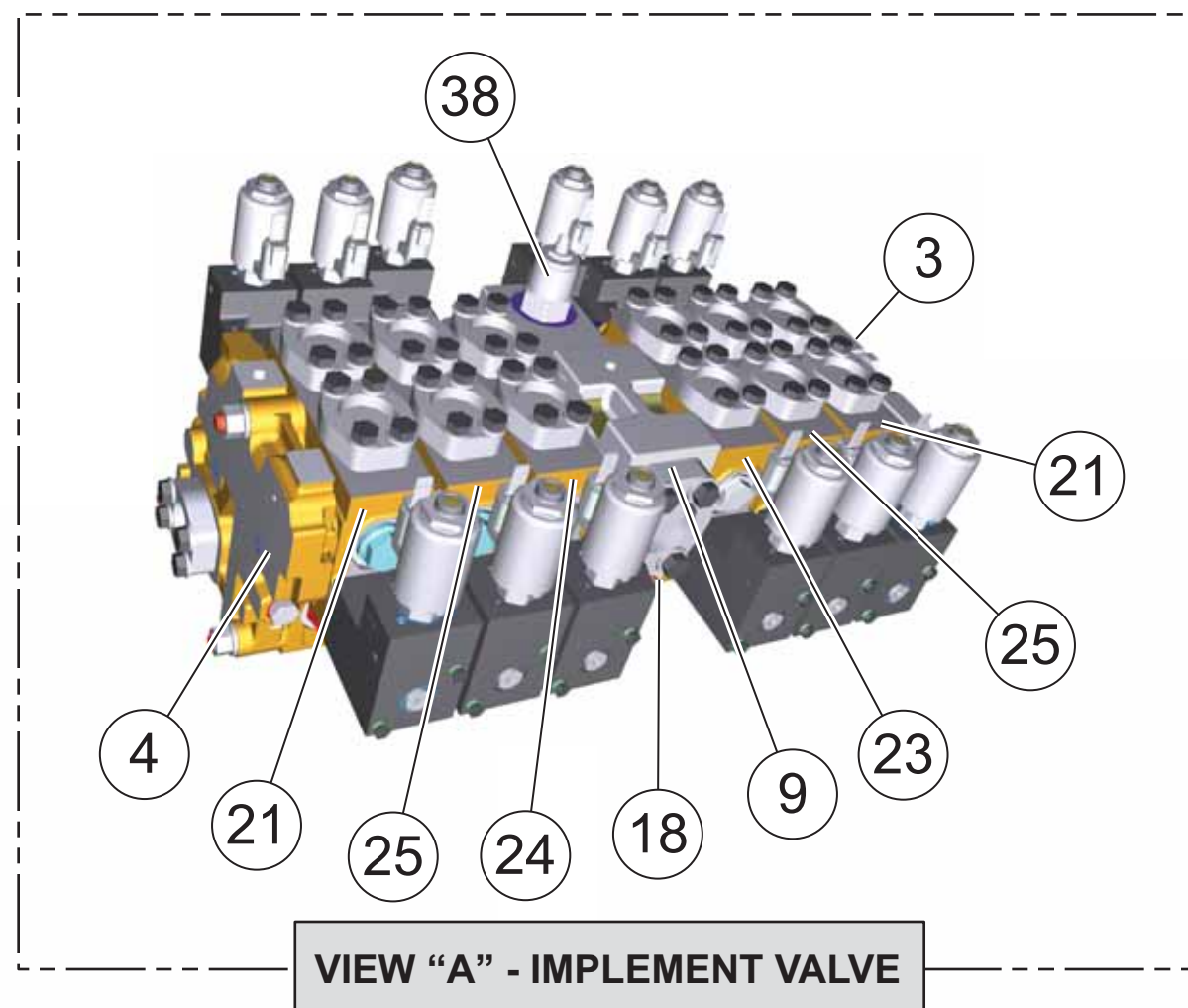

VIEW "A" - IMPLEMENT VALVE

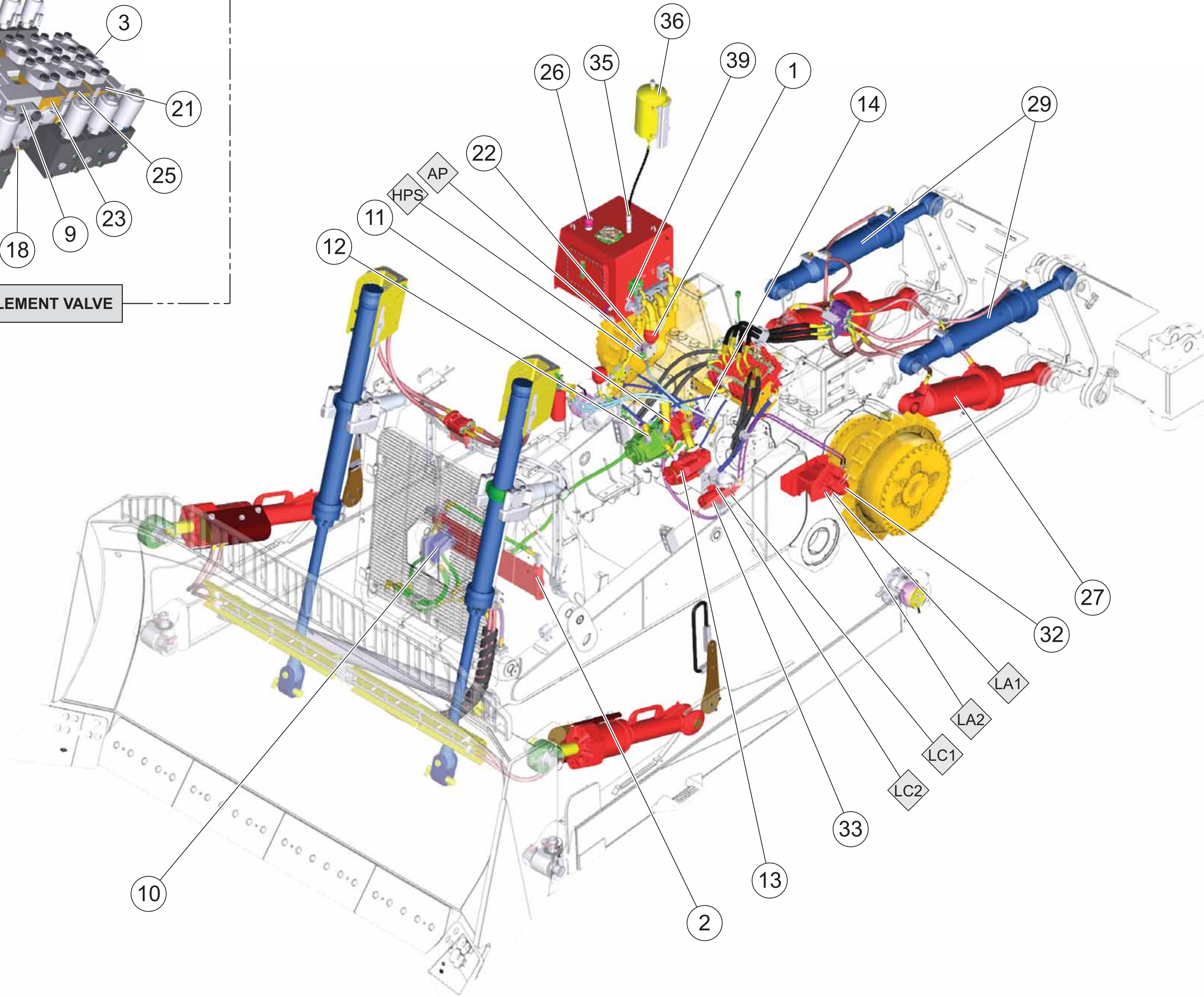

MACHINE VIEWS

Schematic

D10T2 Track-Type Tractor Hydraulic System

RAB1-UP
JW1-UP

© 2014 Caterpillar. All Rights Reserved. Printed in U.S.A.

FLUID POWER SYMBOLS			
BASIC COMPONENT SYMBOLS			
PUMP OR MOTOR	FLUID CONDITIONER	RESTRICTION	LINE RESTRICTION
CONTROL VALVES	LINE RESTRICTION	HYDRAULIC ENERGY STORAGE	HYDRAULIC ENERGY STORAGE
VALVE ENVELOPES	VALVES	VALVE PORTS	CHECK VALVES
CONTROL VALVES	VALVES	CHECK VALVES	FLUID STORAGE RESERVOIRS
FLUID STORAGE RESERVOIRS	MEASUREMENT	ROTATING SHAFTS	COMBINATION CONTROLS
COMBINATION CONTROLS	MANUAL CONTROL SYMBOLS	PILOT CONTROL SYMBOLS	REMOTE SUPPLY PRESSURE
PILOT CONTROL SYMBOLS	REMOTE SUPPLY PRESSURE	ACCUMULATORS	CROSSING & JOINING LINES
CROSSING & JOINING LINES	HYDRAULIC & PNEUMATIC CYLINDERS	HYDRAULIC PUMPS	HYDRAULIC MOTORS
HYDRAULIC PUMPS	HYDRAULIC MOTORS	INTERNAL PASSAGeways	

ELECTRICAL SYMBOLS TABLE			
HYDRAULIC SYMBOLS (ELECTRICAL)			
TRANSDUCER (FLUID)	TRANSDUCER (GAS / AIR)	GENERATOR	ELECTRIC MOTOR
PRESSURE SWITCH	PRESSURE SWITCH (ADJUSTABLE)	TEMPERATURE SWITCH	ELECTRICAL WIRE
ELECTRICAL SYMBOLS (ELECTRICAL)			
PRESSURE SWITCH	TEMPERATURE SWITCH	LEVEL SWITCH	FLOW SWITCH
WIRE NUMBER IDENTIFICATION CODES			
ELECTRICAL SCHEMATIC EXAMPLE		HYDRAULIC SCHEMATIC EXAMPLE	
WIRE NUMBER IDENTIFICATION CODE THIS EXAMPLE INDICATES WIRE 10 IN HARNESS 140		CIRCUIT NUMBER IDENTIFICATION WIRE COLOR	
PREVIOUS STANDARD		EXAMPLE WIRE	

