

Machine Location	Component	Schematic Location	Machine Location	Component	Schematic Location
1	Alarm-Backup	E-9	13	Starter	E-2
2	Alarm-Fuel (EMS)	D-8	14	Switch-Backup Alarm	E-7
3	Batteries	F-5.6	15	Switch-Blower Speed (A/C)	E-6
4	Blower-Alternator	E-8	16	Switch-Blower Fan	F-5
5	Blower-Blower Motor	F-7.1	17	Switch-Blower Fan (EMS)	B-2
6	Blower-Blower Motor (Monitor)	C-8	18	Switch-Engine Coolant Flow (EMS)	B-1
7	Gauge-Engine Coolant Temperature	A-5	19	Switch-Engine Coolant Temperature (EMS)	B-2
8	Gauge-Hydraulic Oil Temperature	B-5	20	Switch-Engine Oil Pressure (Service Meter)	B-2
9	Gauge-Power Train Oil Temperature	E-1	21	Switch-Engine Oil Pressure (Service Meter)	C-5
10	Horn-Forward	A-4	22	Switch-Forward Horn	A-7
11	Motor-Service	A-5	23	Switch-Fuel Pressure (EM)	B-2
12	Motor-Blower	D-4	24	Switch-Hydraulic Oil Temperature (EMS)	A-7
13	Motor-Washer	A-8	25	Switch-Neutral/Blat	D-7
14	Motor-Wiper (Front)	B-4	26	Switch-Power Train Filter (Off Press.)	A-8
15	Motor-Wiper (Left)	F-2	27	Switch-Power Train Oil Temperature (EMS)	A-3
16	Motor-Wiper (Right)	D-4	28	Switch-Relief Pressure (A/C)	A-2
17	Relay-Idle Power	F-9			
18	Relay-Start	F-7			
19	Resistor-Blower Motor Speed	C-4			
20	Resistor-Blower Motor Speed	C-4			
21	Resistor-Blower Motor Speed	C-4			
22	Resistor-Blower Motor Speed	C-4			
23	Resistor-Blower Motor Speed	C-4			
24	Resistor-Blower Motor Speed	C-4			
25	Resistor-Blower Motor Speed	C-4			
26	Resistor-Blower Motor Speed	C-4			
27	Resistor-Blower Motor Speed	C-4			
28	Resistor-Blower Motor Speed	C-4			

A - COMPONENTS INSIDE THE CAB
B - COMPONENTS ON THE RELAY PANEL

Schematic

D8N Track-Type Tractor Electrical System

97C1-UP
1XJ1-UP

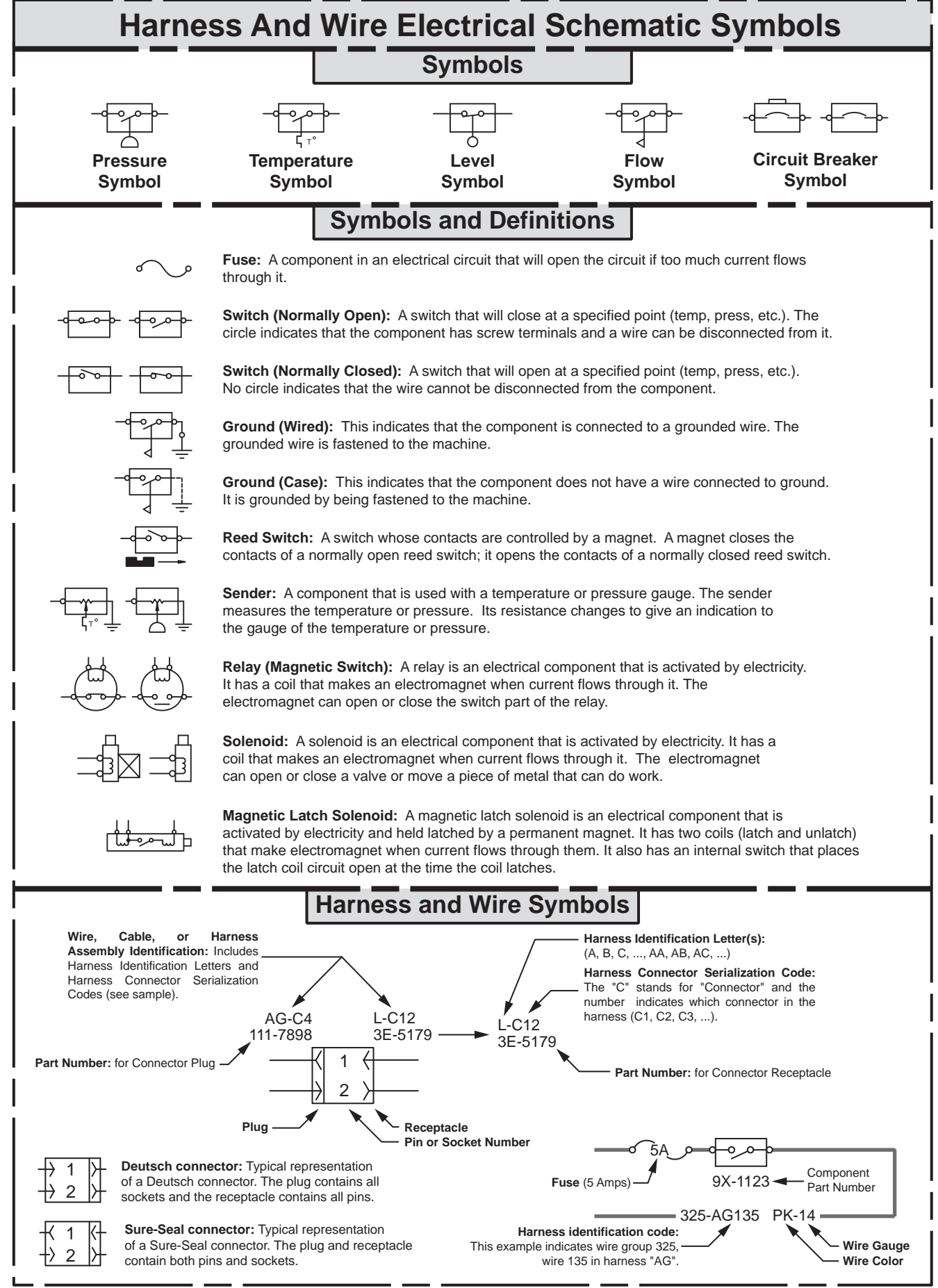

© 2010 Caterpillar
All Rights Reserved
Printed in U.S.A.

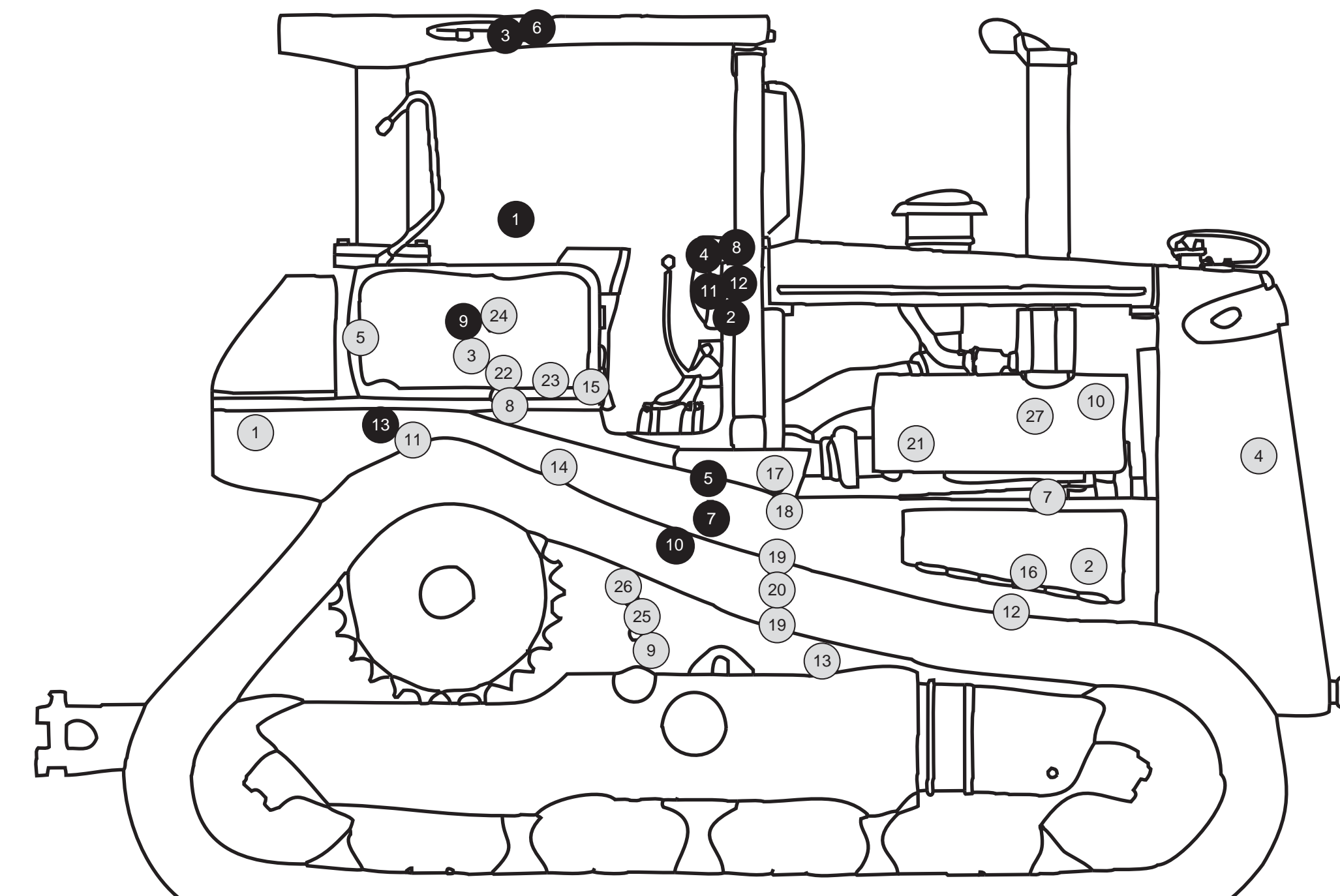

Connectors	Machine Location	Harness Location	Schematic Location	Connectors	Machine Location	Harness Location	Schematic Location
20 CONTACTS	1	C-7	E-4	7	A-7	C-2	C-2
20 CONTACTS	2	C-7	E-4	8	A-7	C-2	C-2
20 CONTACTS	3	C-7	E-4	9	A-7	C-2	C-2
20 CONTACTS	4	C-7	E-4	10	A-7	C-2	C-2
20 CONTACTS	5	C-7	E-4	11	A-7	C-2	C-2
20 CONTACTS	6	C-7	E-4	12	A-7	C-2	C-2
20 CONTACTS	7	C-7	E-4	13	A-7	C-2	C-2
20 CONTACTS	8	C-7	E-4	14	A-7	C-2	C-2
20 CONTACTS	9	C-7	E-4	15	A-7	C-2	C-2
20 CONTACTS	10	C-7	E-4	16	A-7	C-2	C-2
20 CONTACTS	11	C-7	E-4	17	A-7	C-2	C-2
20 CONTACTS	12	C-7	E-4	18	A-7	C-2	C-2
20 CONTACTS	13	C-7	E-4	19	A-7	C-2	C-2
20 CONTACTS	14	C-7	E-4	20	A-7	C-2	C-2
20 CONTACTS	15	C-7	E-4	21	A-7	C-2	C-2
20 CONTACTS	16	C-7	E-4	22	A-7	C-2	C-2
20 CONTACTS	17	C-7	E-4	23	A-7	C-2	C-2
20 CONTACTS	18	C-7	E-4	24	A-7	C-2	C-2
20 CONTACTS	19	C-7	E-4	25	A-7	C-2	C-2
20 CONTACTS	20	C-7	E-4	26	A-7	C-2	C-2
20 CONTACTS	21	C-7	E-4	27	A-7	C-2	C-2
20 CONTACTS	22	C-7	E-4	28	A-7	C-2	C-2

Part No.	Function	Actuate	Deactuate	Contact Position
375825	Power Train Oil Temp. (EMS)	129.4 ± 2.8°C (265 ± 5°F)	118.3°C MIN (245°F MIN)	N.C.
674949	Engine Oil Pressure (EMS)	89 ± 21 kPa (13.0 ± 3.0 psig)	69 ± 21 kPa (10.0 ± 3.0 psig)	N.O.
678316	Engine Coolant Flow (EMS)	1.3 ± 0.1 gal (1.1 ± 0.1 gal)	1.1 ± 0.1 gal	N.O.
790785	Engine Coolant Temp. (EMS)	107.2 ± 2.8°C (225 ± 5°F)	91.0°C MIN (196°F MIN)	N.C.
8K2248	Hydraulic Oil Temperature (EMS)	101.7 ± 2.8°C (215 ± 5°F)	83.3°C MIN (200°F MIN)	N.C.
903341	Power Train Oil Temp. (Filter) (EMS)	51.7 ± 2.2°C (125 ± 5°F)	45.0°C MIN (110°F MIN)	N.C.
9W3187	Fuel Pressure (EMS)	93 ± 21 kPa (13.5 ± 3.0 psig)	69 ± 21 kPa (10.0 ± 3.0 psig)	N.C.

N.O. = NORMALLY OPEN N.C. = NORMALLY CLOSED

Wire Number	Wire Color	Description	Wire Number	Wire Color	Description
101	BU	BATTERY	401	GN	ALTERNATOR R TERMINAL
102	BU	HEAD LAMP	402	GN	ALTERNATOR R TERMINAL
103	BU	DOOR LAMP/PARK TAIL LAMP	403	GN	ALTERNATOR R TERMINAL
104	BU	KEY SWITCH	404	GN	ALTERNATOR R TERMINAL
105	WH	MAIN POWER RELAY/INPUT	405	GN	ALTERNATOR R TERMINAL
106	WH	ENGINE SHUT DOWN	406	GN	ALTERNATOR R TERMINAL
107	WH	MISC WIPER LAMP, DIGITAL LIGHTER	407	GN	ALTERNATOR R TERMINAL
108	BU	WINDSHIELD WIPER SW (LEFT)	408	GN	ALTERNATOR R TERMINAL
109	GN	WINDSHIELD WIPER SW (RIGHT)	409	GN	ALTERNATOR R TERMINAL
110	PU	MAIN POWER RELAY/OUTPUT	410	GN	ALTERNATOR R TERMINAL
111	GN	OPERATOR MON PANEL FUEL PRESS	411	GN	ALTERNATOR R TERMINAL
112	PU	WINDSHIELD WIPER SW (LEFT)	412	GN	ALTERNATOR R TERMINAL
113	GN	WINDSHIELD WIPER SW (RIGHT)	413	GN	ALTERNATOR R TERMINAL
114	GN	WINDSHIELD WIPER SW (RIGHT)	414	GN	ALTERNATOR R TERMINAL
115	PK	FLOOD LAMP (REAR)	415	GN	ALTERNATOR R TERMINAL
116	PK	FLOOD LAMP (REAR)	416	GN	ALTERNATOR R TERMINAL
117	YL	WINDSHIELD WIPER SW (FRONT)	417	GN	ALTERNATOR R TERMINAL
118	GY	WINDSHIELD WIPER SW (FRONT)	418	GN	ALTERNATOR R TERMINAL
119	PK	WINDSHIELD WIPER SW (REAR)	419	GN	ALTERNATOR R TERMINAL
120	YL	WINDSHIELD WIPER SW (REAR)	420	GN	ALTERNATOR R TERMINAL
121	YL	WINDSHIELD WIPER SW (REAR)	421	GN	ALTERNATOR R TERMINAL
122	BU	AIR DRYER	422	GN	ALTERNATOR R TERMINAL
123	WH	CHARGE INDICATOR/CHARGE, TORQUE CONV	423	GN	ALTERNATOR R TERMINAL
124	GN	WINDSHIELD WIPER SW (REAR)	424	GN	ALTERNATOR R TERMINAL
125	PK	WINDSHIELD WIPER SW (REAR)	425	GN	ALTERNATOR R TERMINAL
126	PK	WINDSHIELD WIPER SW (REAR)	426	GN	ALTERNATOR R TERMINAL
127	GN	WINDSHIELD WIPER SW (REAR)	427	GN	ALTERNATOR R TERMINAL
128	PK	WINDSHIELD WIPER SW (REAR)	428	GN	ALTERNATOR R TERMINAL
129	GN	WINDSHIELD WIPER SW (REAR)	429	GN	ALTERNATOR R TERMINAL
130	GN	WINDSHIELD WIPER SW (REAR)	430	GN	ALTERNATOR R TERMINAL
131	GN	WINDSHIELD WIPER SW (REAR)	431	GN	ALTERNATOR R TERMINAL
132	GN	WINDSHIELD WIPER SW (REAR)	432	GN	ALTERNATOR R TERMINAL
133	GN	WINDSHIELD WIPER SW (REAR)	433	GN	ALTERNATOR R TERMINAL
134	GN	WINDSHIELD WIPER SW (REAR)	434	GN	ALTERNATOR R TERMINAL
135	BU	WINDSHIELD WIPER SW (REAR)	435	GN	ALTERNATOR R TERMINAL
136	GN	WINDSHIELD WIPER SW (REAR)	436	GN	ALTERNATOR R TERMINAL
137	GN	WINDSHIELD WIPER SW (REAR)	437	GN	ALTERNATOR R TERMINAL
138	GN	WINDSHIELD WIPER SW (REAR)	438	GN	ALTERNATOR R TERMINAL
139	GN	WINDSHIELD WIPER SW (REAR)	439	GN	ALTERNATOR R TERMINAL
140	GN	WINDSHIELD WIPER SW (REAR)	440	GN	ALTERNATOR R TERMINAL
141	GN	WINDSHIELD WIPER SW (REAR)	441	GN	ALTERNATOR R TERMINAL
142	GN	WINDSHIELD WIPER SW (REAR)	442	GN	ALTERNATOR R TERMINAL
143	GN	WINDSHIELD WIPER SW (REAR)	443	GN	ALTERNATOR R TERMINAL
144	GN	WINDSHIELD WIPER SW (REAR)	444	GN	ALTERNATOR R TERMINAL
145	GN	WINDSHIELD WIPER SW (REAR)	445	GN	ALTERNATOR R TERMINAL
146	GN	WINDSHIELD WIPER SW (REAR)	446	GN	ALTERNATOR R TERMINAL
147	GN	WINDSHIELD WIPER SW (REAR)	447	GN	ALTERNATOR R TERMINAL
148	GN	WINDSHIELD WIPER SW (REAR)	448	GN	ALTERNATOR R TERMINAL
149	GN	WINDSHIELD WIPER SW (REAR)	449	GN	ALTERNATOR R TERMINAL
150	GN	WINDSHIELD WIPER SW (REAR)	450	GN	ALTERNATOR R TERMINAL

SEN3417-01
20 Page, (Dimensions: 39 inches x 24 inches)

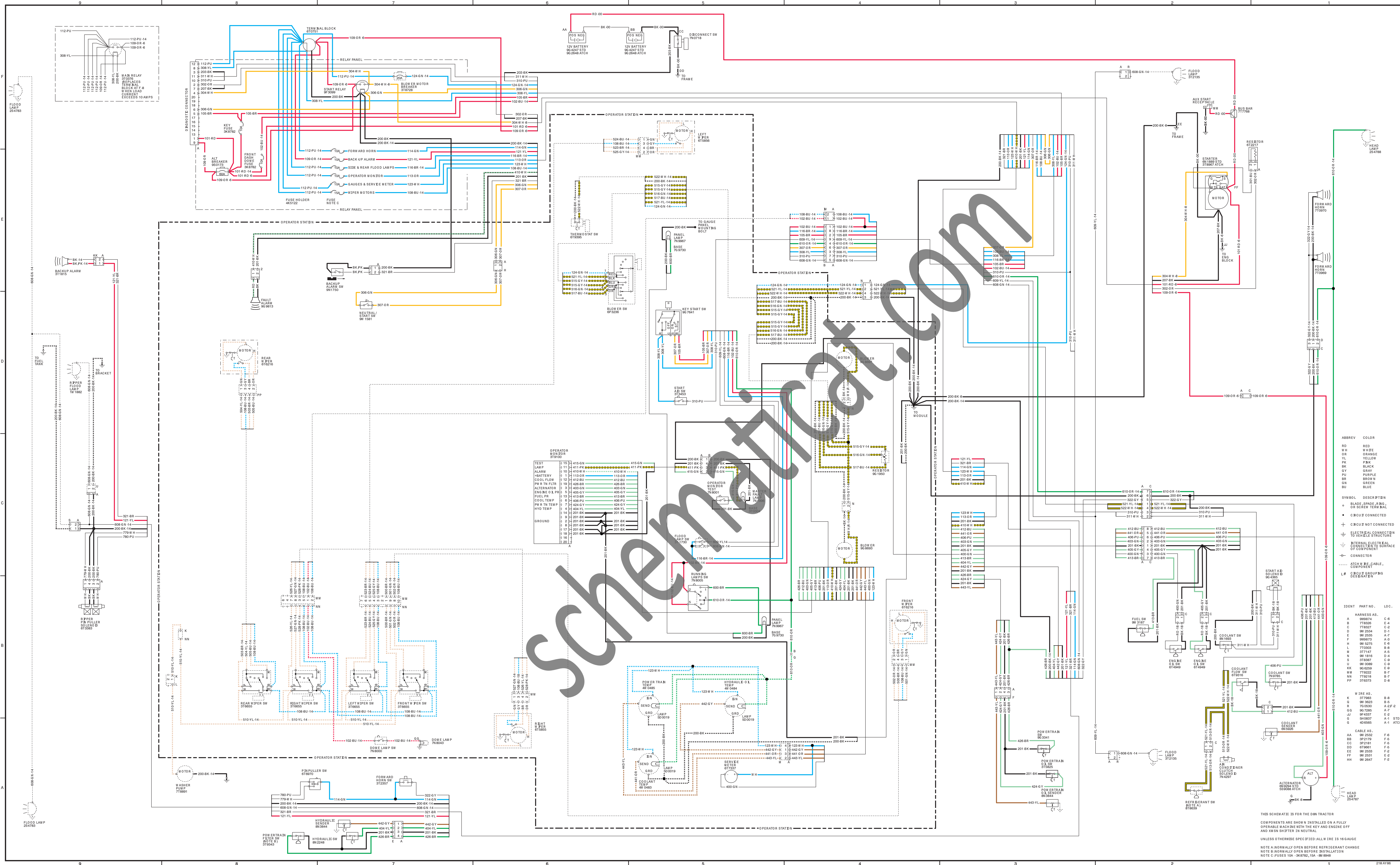

THIS SCHEMATIC IS FOR THE D6N TRACTOR
COMPONENTS ARE SHOWN INSTALLED ON A FULLY OPERABLE MACHINE WITH THE KEY AND ENGINE OFF AND WIPER SWITCH IN NEUTRAL
UNLESS OTHERWISE SPECIFIED ALL WIRE IS 16 GAUGE
NOTE: AIR CONDITIONER CIRCUIT IS NOT SHOWN
NOTE: AIR CONDITIONER CIRCUIT IS NOT SHOWN
NOTE: AIR CONDITIONER CIRCUIT IS NOT SHOWN