

# Schematic

315B, 317B and 318B Excavators  
Hydraulic System - Attachment  
Stick Lowering Control Valve

315B L: 5SW1-Up    317B L: 9WW1-Up    317B LN: 6DZ1-Up    318B L: ADC1-Up    318B LN: AEJ1-Up

FLUID POWER SYMBOLS											
BASIC COMPONENT SYMBOLS											
VALVES											
VALVE ENVELOPES				VALVES				VALVE PORTS			
CONTROL VALVES						CHECK VALVES					
MEASUREMENT						ROTATING SHAFTS					
FLUID STORAGE RESERVOIRS											
COMBINATION CONTROLS											
MANUAL CONTROL SYMBOLS											
PILOT CONTROL SYMBOLS											
RELEASED PRESSURE						REMOTE SUPPLY PRESSURE					
ACCUMULATORS				CROSSING AND JOINING LINES				HYDRAULIC AND PNEUMATIC CYLINDERS			
HYDRAULIC PUMPS				HYDRAULIC MOTORS				INTERNAL PASSAGEWAYS			

© 2006 Caterpillar  
All Rights Reserved

Printed in U.S.A.

## Electrical Symbols Table

Hydraulic Symbols (Electrical)			
Transducer (Fluid)	Transducer (Gas / Air)	Generator	Electric Motor
Pressure Switch	Pressure Switch (Adjustable)	Temperature Switch	Electrical Wire
Electrical Symbols (Electrical)			
Pressure Symbol	Temperature Symbol	Level Symbol	Flow Symbol
Wire Number Identification Codes			
Electrical Schematic Example		Hydraulic Schematic Example	
<p><b>Current Standard</b></p> <p>Harness identification code This example indicates wire 135 in harness "AG".</p> <p>325-AG135-PK-14</p> <p>Wire Identification Number    Wire Color    Wire Gauge</p>		<p><b>Current Standard</b></p> <p>Circuit Number Identification    Wire Color</p> <p>325-PK</p> <p>325-PK-14</p> <p>Circuit Number Identification    Wire Gauge</p> <p>(EXAMPLE VALVE)</p>	
<p><b>Previous Standard</b></p> <p>325-PK-14</p> <p>Wire Identification Number    Wire Color    Wire Gauge</p>		<p>325-PK-14</p> <p>Circuit Number Identification    Wire Gauge</p>	

**Hydraulic Schematic**  
148-9065

This Attachment Schematic is intended to be used in conjunction with the Standard Hydraulic Schematic in the Service Manual

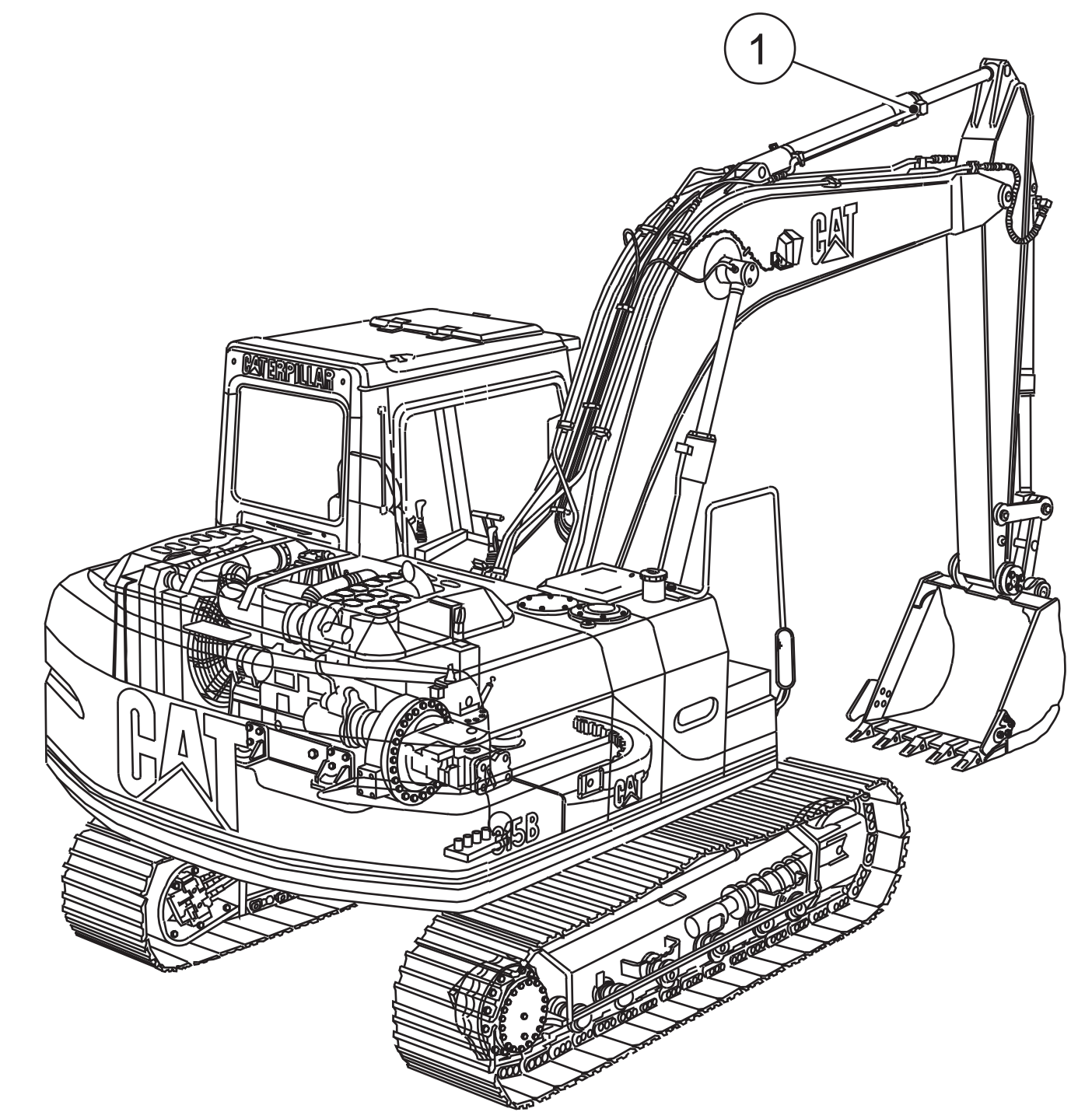
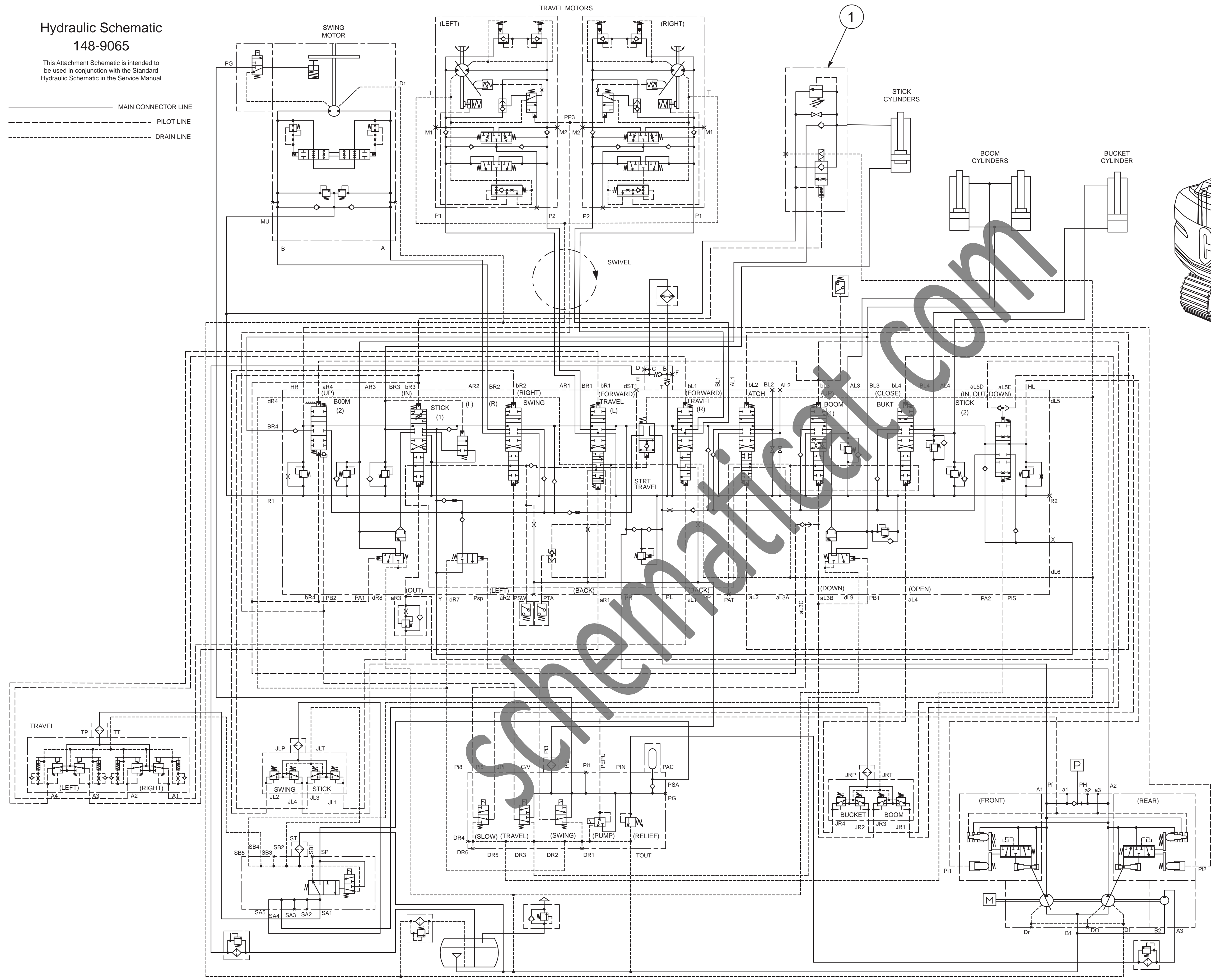
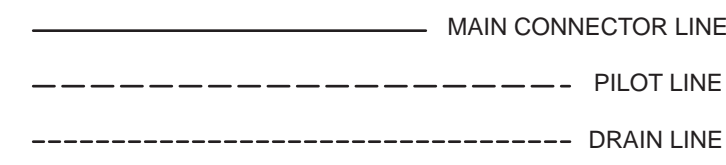

Attachment Components	
Item No.	Description
1	Stick Lowering Control Valve