

Component Locations			
Description	Part Number	Machine Location	Schematic Location
Steering Components			
Cylinder Gp - Steering	770: 276-5246 772: 276-5249	1	E-5
Filter Gp - Steering	249-2334	2	A-6
Filter Gp - Steering / Pump Rtm	173-0159	3	A-6
Pump Gp - Metering	192-4296	4	D-5
Pump Gp - Steering (Primary)	219-1964	5	B-5
Pump Gp - Steering (Secondary)	230-2837	6	C-7
Switch As - Sec. Steering Load	9X-4455	7	C-8
Switch As - Steering Primary Low Pressure	3E-6450	8	C-6
Tank Gp - Steering	280-9600	9	A-6
Valve Gp - Breaker	9T-0818	10	B-8
Valve Gp - Check (Steering)	175-7050	11	D-8
Valve Gp - Steering Disable	277-8869	12	B-6
Service And Parking Brakes, Brake Cooling, Fan, Hoist and Traction Control System (Attachment)			
Accumulator Gp - Brake	220-5692	20	H-11, H-4
Adjuster Gp - Rear Brake Stack	252-2145	21	H-14, H-7
Brake Gp - Front Service Brakes	125-1364	22	H-8, H-1
Brake Gp - Rear Brakes	770: 238-6841 772: 238-1266	23	J-14, F-14, E-14 A-14, J-7, F-7
Cleaner As - Hoist Tank	294-2090	24	F-11, F-4
Control Gp - Brake Retract	222-4744	25	G-12, G-5
Control Gp - Foot Brake	310-7260	62	H-9, H-2
Cylinder Gp - Hoist	273-4989	26	A-10
Elbow - 45 Deg Orificed	260-9199	27	I-9, I-2
Filter Gp - Brake/ Fan System	155-6061	28	G-10, G-3
Motor Gp - Fan	770: 273-3802 772: 273-3903	29	G-9, E-3, G-2
Oil Cooler	288-9746	30	C-12
Orifice Plate - Hoist	8X-3572	31	A-10
Plate - Orifice	194-1624	32	A-10
Pump Gp - Brake Retract	230-2837	33	G-11, G-4
Pump Gp - Brake/ Fan	770: 280-7490 772: 281-0106	34	G-3, G-10
Pump Gp - Hoist	770: 280-7490 772: 281-0106	35	G-10, G-3
Screen - Brake Cooling	6E-6640	36	C-12
Screen As - Brk Cooling Return	9T-9227	37	B-12
Screen As - Hoist Pump Suction	239-8460	38	B-11
Sensor Gp - Brk Accum. Press.	214-6863	39	H-10, H-3
Switch As - Service Brk Press.	128-5091	40	I-10, I-3
Switch Gp - Park Brake Status	160-2609	41	I-13, I-6
Tank Gp - Hoist	261-4550	42	F-12, F-5, B-12
Valve Gp - Accum. Charging	275-6962	43	H-10, H-3
Valve Gp - Brake	289-0586	44	I-13, I-6
Valve Gp - Brake Retract Relief	228-7839	45	I-11, I-4
Valve Gp - Cab Manifold	248-0054	46	I-10, I-3
Valve Gp - Check (Brake Retr.)	185-4026	47	G-11, G-4
Valve Gp - Diverter	3G-2887	48	I-12, I-4
Valve Gp - Fan Speed Control	270-0510	49	G-9, G-2
Valve Gp - Hoist Control	245-1669	50	C-10
Valve Gp - Pilot Press. Reducing	228-7838	51	H-12, H-5
Valve Gp - Service Brake Pedal	218-7311	52	I-9, I-2
Valve Gp - Shuttle	8J-6875	63	H-9, H-2
Optional Attachments			
Valve Gp - Diverter Box Control	298-6175	60	E-3
Cylinder Gp - Actuating Cylinder	278-4526	61	D-4

Tap Locations Pressure, Sampling, and Sensor		
Tap Number	Description	Schematic Location
A	Left Rear Service Brake Pressure	J-14, J-7
B	Right Rear Service Brake Pressure	F-14, F-7
C	Stack Adjuster Inlet Pressure	H-14, H-7
D	Left Park Brake Pressure	H-13, H-6
E	Right Park Brake Pressure	G-13, G-6
F	LHS TCS Park Brake Pressure	H-13, H-6
G	RHS TCS Park Brake Pressure	G-13, G-6
H	Service Brake Pressure	I-10, I-3
I	Front Service Brake Pressure	H-9, H-2
J	Service Brake Accumulator Pressure	I-10, I-3
K	Park Brake Accumulator Pressure	I-11, I-4
L	Accumulator Charging Pressure	H-10, H-3
M	Fan Motor Inlet	G-9, G-2, E-3
N	Fan Motor Outlet	G-9, G-2, E-3
O	Brake Pump Pressure	G-11, G-4
P	Brake Cooling Pressure	E-13
Q	System Oil Sampling - Brake Cooling Oil	C-12
R	Hoist Cylinder Head End	A-11
S	Hoist Cylinder Rod End	A-10
T	Hoist Pump Pressure	B-11
U	Hoist Valve Lower Pilot Pressure	C-9
V	Hoist Valve Raise Pilot Pressure	B-9
W	Primary Steering Pressure	D-5
X	Steering Load Sensing Pilot Pressure	C-8
Y	System Oil Sampling - Steering Oil	B-8

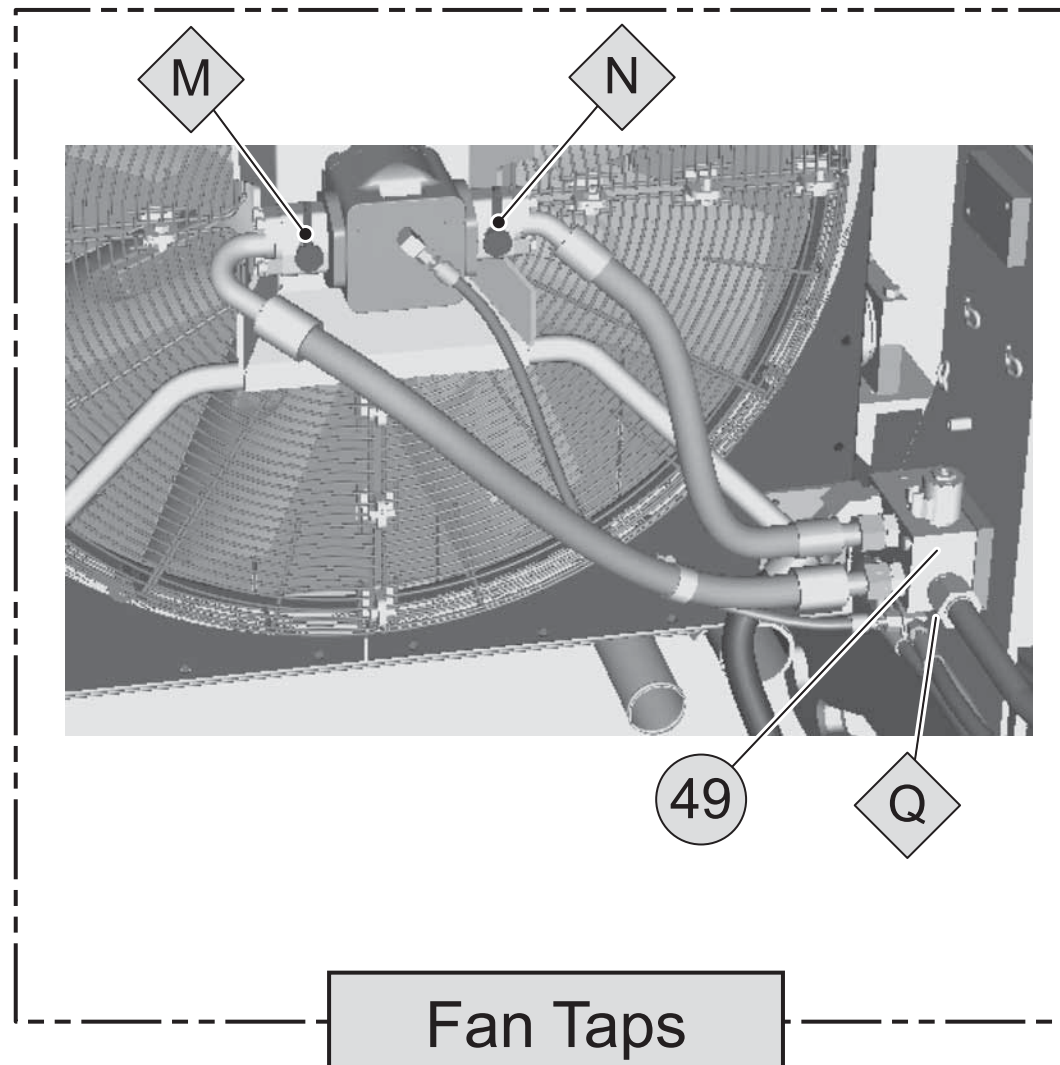

Fan Taps

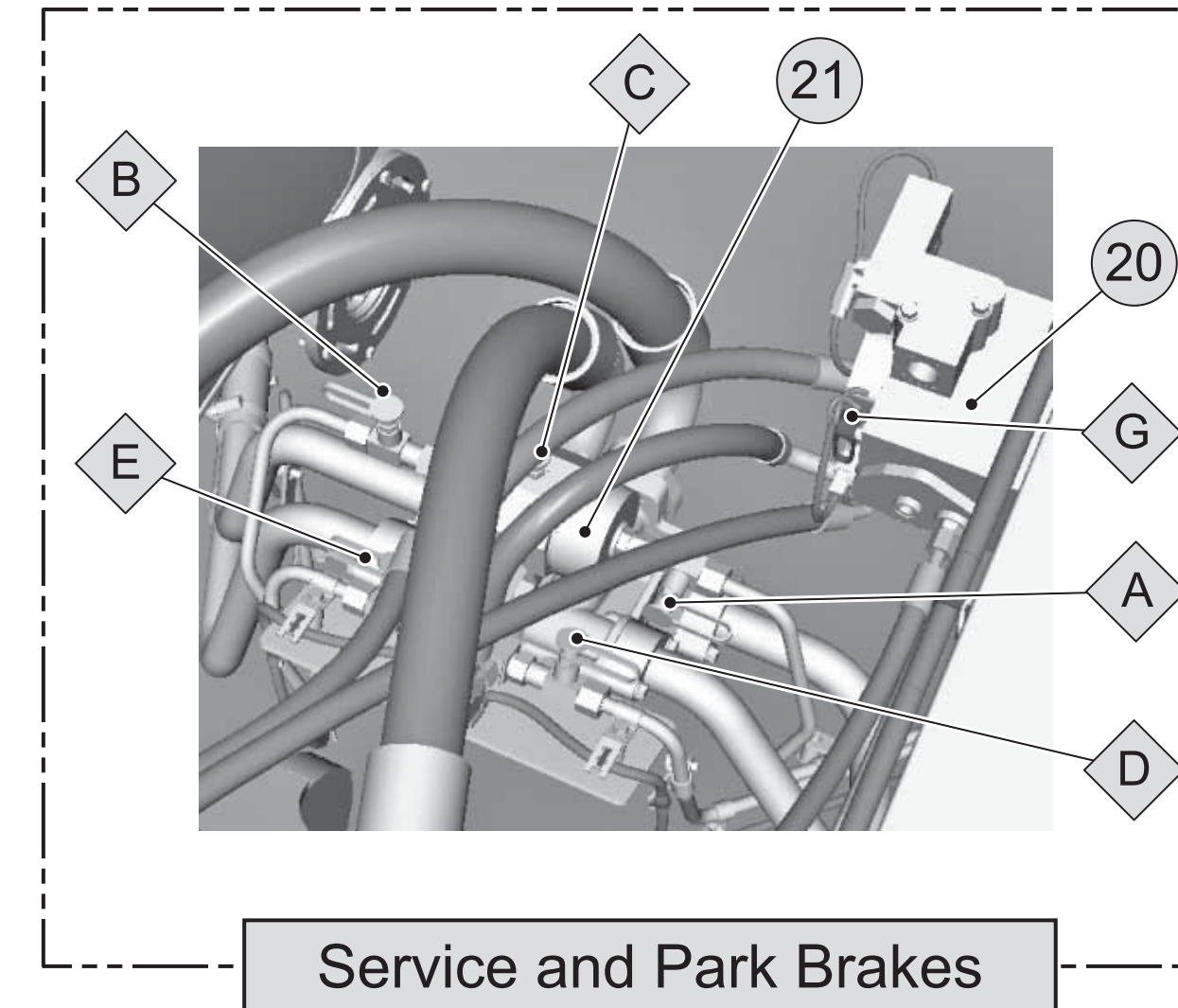

Service and Park Brakes

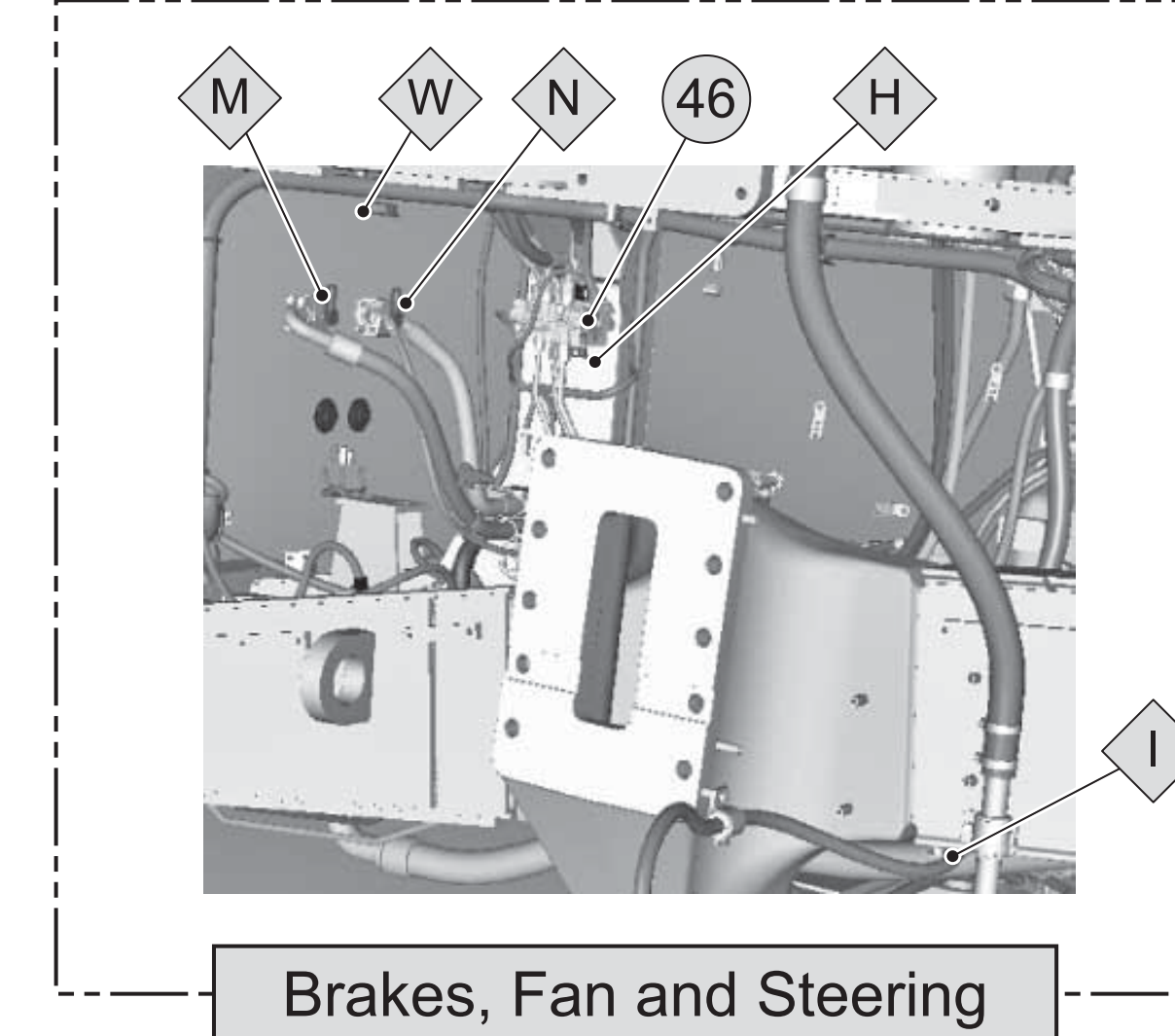

Brakes, Fan and Steering

Schematic

770 and 772 Off-Highway Trucks Hydraulic System

770: BZZ1-UP
772: RLB1-UP

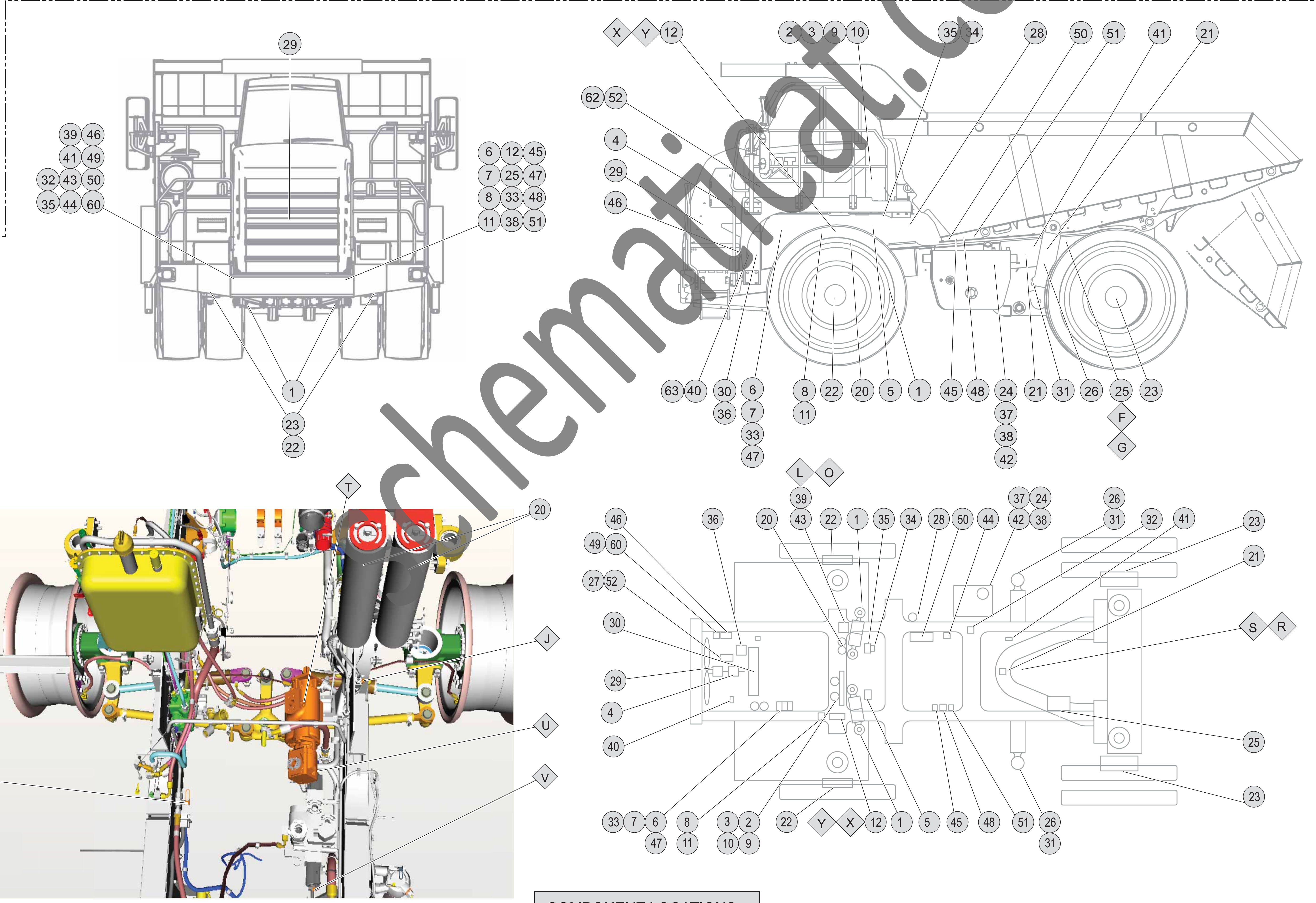

COMPONENT LOCATIONS

FLUID POWER SYMBOLS			
BASIC COMPONENT SYMBOLS			
PUMP MOTOR	FLUID CONDITIONER	SPRING	CONTROL VALVE
VALVE ENVELOPE	VALVE	VALVE PORTS	FLUID STORAGE RESERVOIRS
CONTROL VALVES	CHECK VALVES	FLUID STORAGE RESERVOIRS	ROTATING SHAFTS
MEASUREMENT	COMBINATION CONTROLS	MANUAL CONTROL SYMBOLS	RELEASED PRESSURE
ACCUMULATORS	CROSSING & JOINING LINES	HYDRAULIC & PNEUMATIC CYLINDERS	HYDRAULIC PUMPS
HYDRAULIC PUMPS	HYDRAULIC MOTORS	INTERNAL PASSAGEWAYS	

ELECTRICAL SYMBOLS TABLE			
HYDRAULIC SYMBOLS (ELECTRICAL)			
TRANSDUCER (FLUID)	TRANSDUCER (GAS / AIR)	GENERATOR	ELECTRIC MOTOR
PRESSURE SWITCH	PRESSURE SWITCH (ADJUSTABLE)	TEMPERATURE SWITCH	ELECTRICAL WIRE
ELECTRICAL SYMBOLS (ELECTRICAL)			
PRESSURE SWITCH	TEMPERATURE SWITCH	LEVEL SWITCH	FLOW SWITCH
WIRE NUMBER IDENTIFICATION CODES			
ELECTRICAL SCHEMATIC EXAMPLE		HYDRAULIC SCHEMATIC EXAMPLE	
CURRENT STANDARD		CURRENT STANDARD	
PREVIOUS STANDARD		PREVIOUS STANDARD	

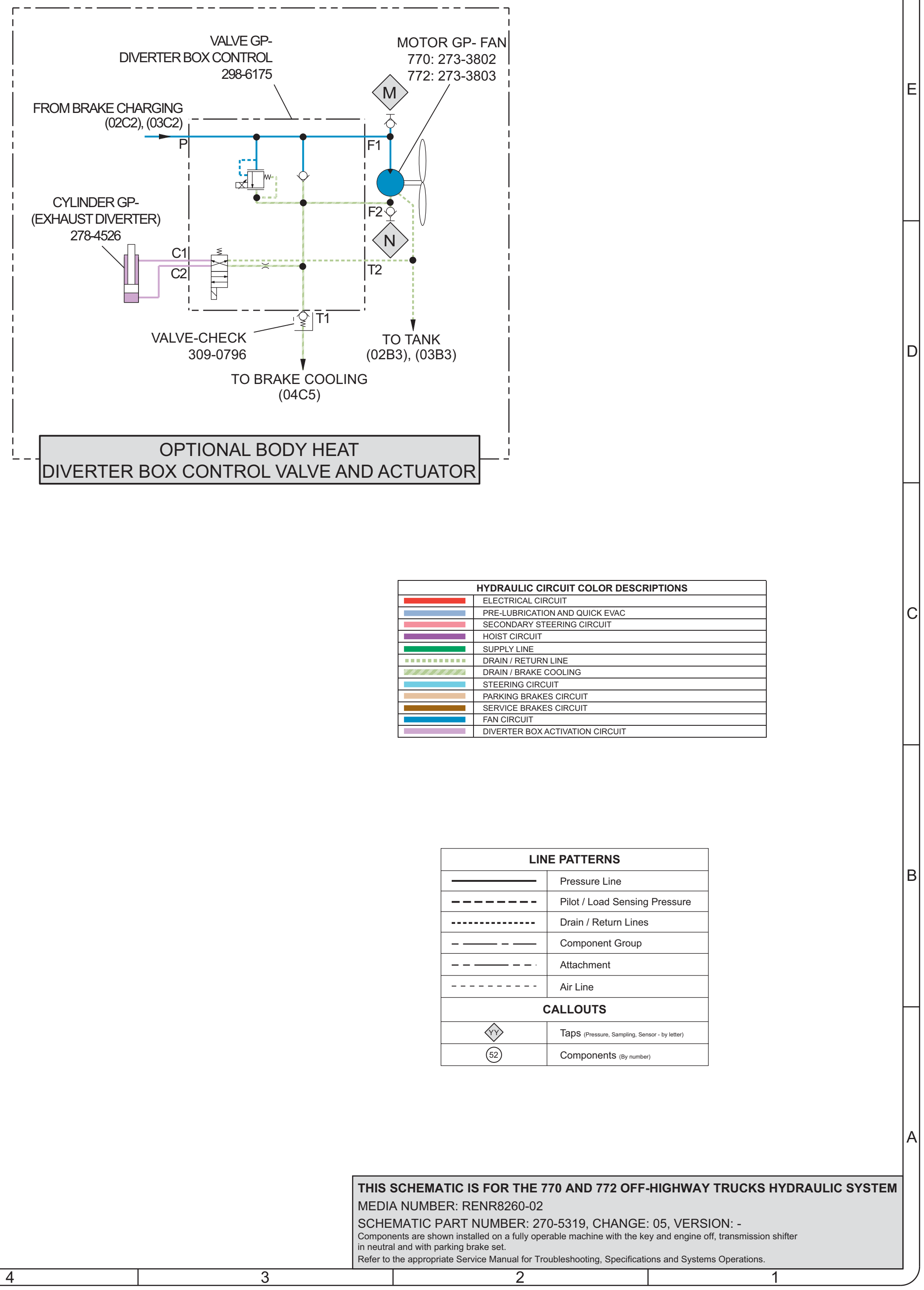
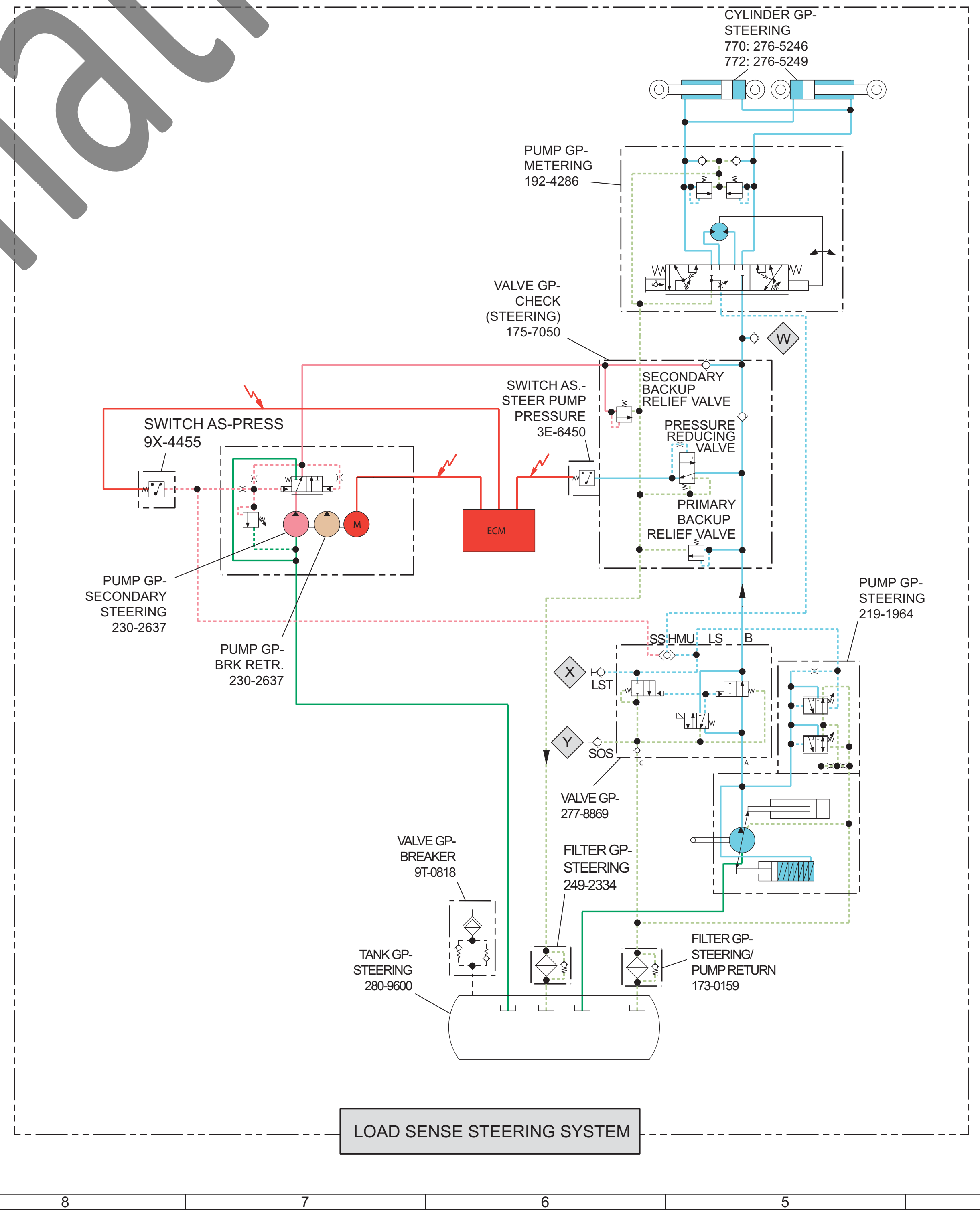
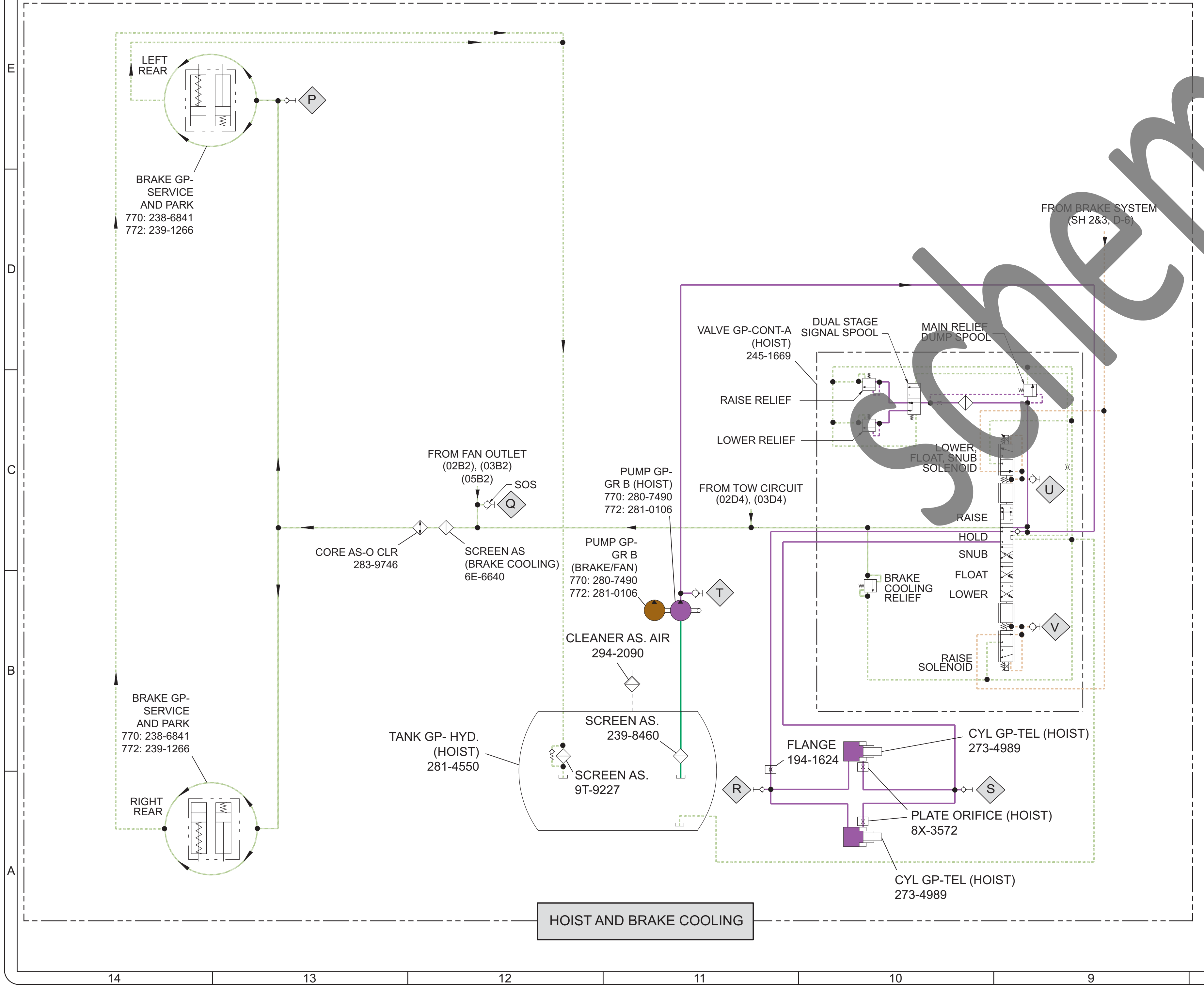
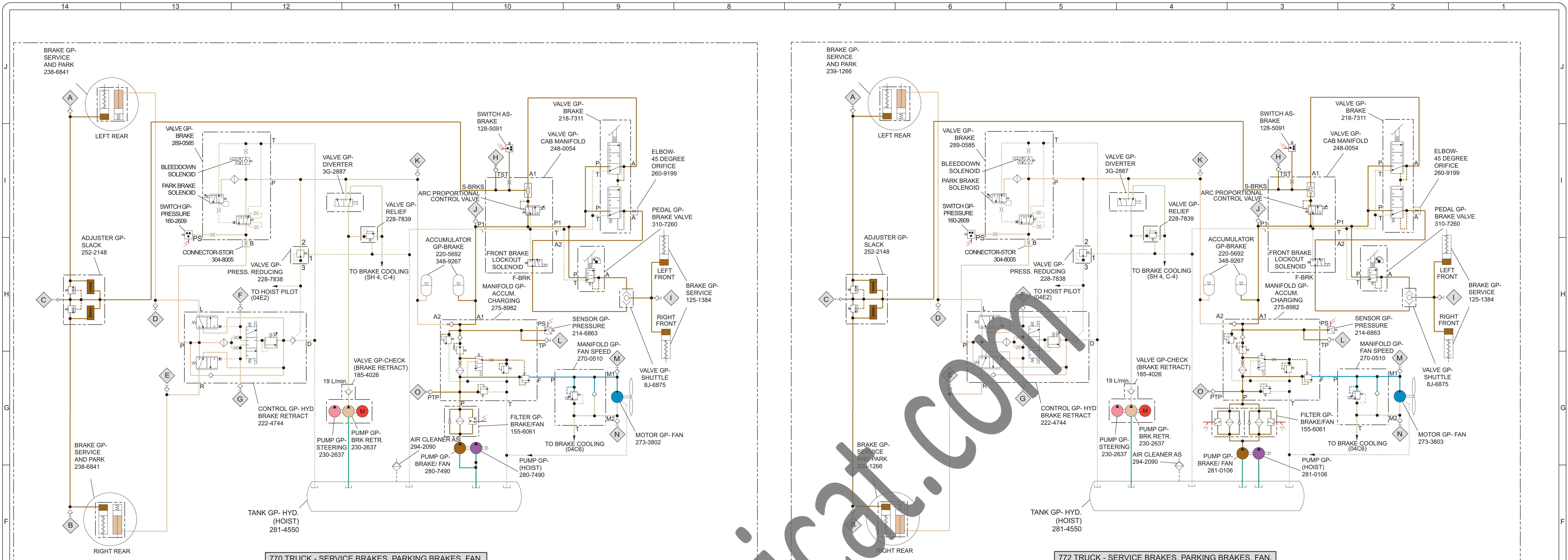

HYDRAULIC CIRCUIT COLOR DESCRIPTIONS	
Red	ELECTRICAL CIRCUIT
Blue	PRE LUBRICATION AND QUICK EXING
Green	SECONDARY STEERING CIRCUIT
Purple	HOIST CIRCUIT
Black	SUPPLY LINE
Black	DRAIN / RETURN LINE
Black	DRAIN / BRAKE COOLING
Black	STEERING CIRCUIT
Black	PARKING BRAKES CIRCUIT
Black	SERVICE BRAKES CIRCUIT
Black	FAN CIRCUIT
Black	DIVERTER BOX ACTIVATION CIRCUIT

LINE PATTERNS	
—	Pressure Line
- - -	Pilot / Load Sensing Pressure
· · · · ·	Drain / Return Lines
— · — ·	Component Group
- - - - -	Attachment
— · — ·	Air Line

CALLOUTS	
◇	Tap5 Pressure, Sensing Sensor (As Ind)
⊙	Component (As Ind)

THIS SCHEMATIC IS FOR THE 770 AND 772 OFF-HIGHWAY TRUCKS HYDRAULIC SYSTEM
 MEDIA NUMBER: REN8260-02
 SCHEMATIC PART NUMBER: 270-5319, CHANGE: 05, VERSION: -
 Components are shown installed on a fully operable tractor with the key and engine off, transmission in neutral and with parking brake set.
 Refer to the appropriate Service Manual for Troubleshooting, Specifications and Systems Operations.