

## Schematic

### 950G Wheel Loader and 962G Wheel Loader Hydraulic System

- |         |         |         |
|---------|---------|---------|
| 2JS1-UP | 5A31-UP | 6HW1-UP |
| 3BS1-UP | 5FW1-UP | 6NS1-UP |
| 3JW1-UP | 5MW1-UP | 7BW1-UP |
| 4BS1-UP | 5RS1-UP | 8JW1-UP |
| 4PW1-UP | 6EW1-UP | BDP1-UP |

©2000 Caterpillar  
All Rights Reserved

Printed in U.S.A.

Chart C 950G and 962G Hydraulic Component Locations			Chart C 950G and 962G Hydraulic Component Locations		
Item No.	Component	Schematic Location	Item No.	Component	Schematic Location
1	Main Control Valve %	A1	27	Parking Brake Control Valve	C7
2	Auxiliary Cylinders @	A2	28	Steering Cylinders	D7
3	Tilt Cylinder	A3	29	Steering Pilot Valve	D4
4	Lift Cylinders	A4	30	Steering Wheel	D5
5	Front Service Brakes	A5	31	Screen Group	E5
6	Left Pedal Assembly	A6	32	Check Valve	E5
7	Right Pedal Assembly	A6	33	Left Steering Neutralizer Valve	E5
8	Service Brake Control Valve		34	Steering Control Valve	E6
9	Front Service Brakes Accumulator		35	Steering Crossover Relief Valve	E6
10	Rear Service Brakes Accumulator	A7	36	Shuttle Valve	E7
11	Parking Brake		37	Hydraulic Oil Filter	E2
12	Parking Brake Actuator		38	Hydraulic Oil Cooler Bypass Valve	E3
13	Orifice	A3	39	Steering Pump	E1
14	Ride Control Diverter Valve #	A5	40	Hydraulic Oil Cooler	E3
15	Ride Control Accumulator #	A5	41	Implement Pump	F1
16	Main Relief Valve	A1	42	Pilot/Brake Pump	F2
17	Line Relief Valve (Aux. Cylinder Head End) @	A2	43	Fan Drive Pump	F3
18	Line Relief Valve (Aux. Cylinder Rod End) @	A2	44	Fan Drive Motor	F3
19	Line Relief Valve (Tilt Cylinder Rod End)	A3	45	Shuttle Valve	F4
20	Line Relief Valve (Tilt Cylinder Head End)		46	Secondary Steering Valve *	F5
21	Rear Service Brakes	B5	47	Right Steering Neutralizer Valve	F6
22	Accumulator Charging Valve	B6	48	Pressure Reducing Valve	F6
23	Parking Brake Pressure Switch	B7	49	Steering Backup Relief Valve	F7
24	Pilot Valve (Oil Manifold)	C1	50	Secondary Steering Pump and Electric Motor*	F4
25	Lowering Control Valve	C6	51	Breaker Relief Valve	F1
26	Service Brake Oil Pressure Switch	C6	52	Hydraulic Oil Tank	F1

\* Secondary Steering is an optional attachment.

# Ride Control is an optional attachment.

@ Auxiliary Cylinders are an optional attachment.

% The one stem valve (third function) is an optional attachment field conversion.

The two stem valve is standard.

The three stem valve is an optional attachment.

Chart D 950G and 962G Hydraulic Pressure Tap Locations			Chart D 950G and 962G Hydraulic Pressure Tap Locations		
Pressure Tap	Description	Schematic Location	Pressure Tap	Description	Schematic Location
AA	Tilt Cylinder Rod End Pressure		MM	Service Brake Accumulator Pressure	C6
BB	Tilt Cylinder Head End Pressure	A3	NN	Implement Pump Pressure	D1
CC	Rear Service Brake Pressure		PP	Steering Pump Pressure	E1
DD	Front Service Brake Pressure	A5	RR	Fluid Sampling Valve	E2
EE	Auxiliary Pilot Pump Pressure	B1	SS	Steering Pilot Pressure	E6
FF	Auxiliary Pilot Pump Pressure	B1	TT	Fan Drive Pump Pressure	E3
GG	Tilt Pilot Pump Pressure	B2	UU	Steering Control Valve Neutral Pilot Pressure	E4
HH	Tilt Pilot Pump Pressure	B3	VV	Steering Pilot Pressure	F4
JJ	Lift Pilot Pump Pressure		WW	Steering Pilot Pressure	F4
KK	Lift Pilot Pump Pressure	C4	XX	Steering Pump Signal Pressure	F6
LL	Pilot Pump Pressure	C5			

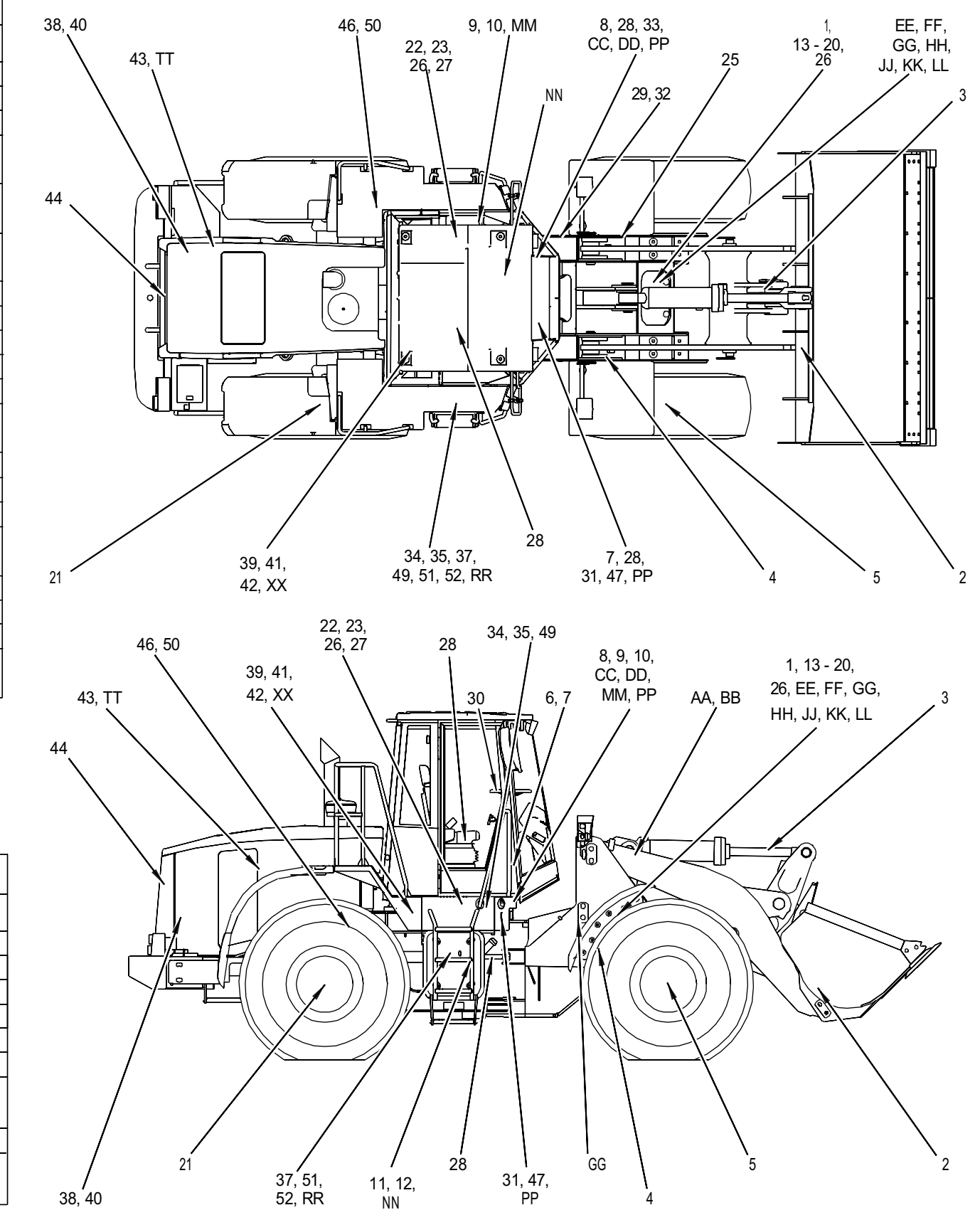

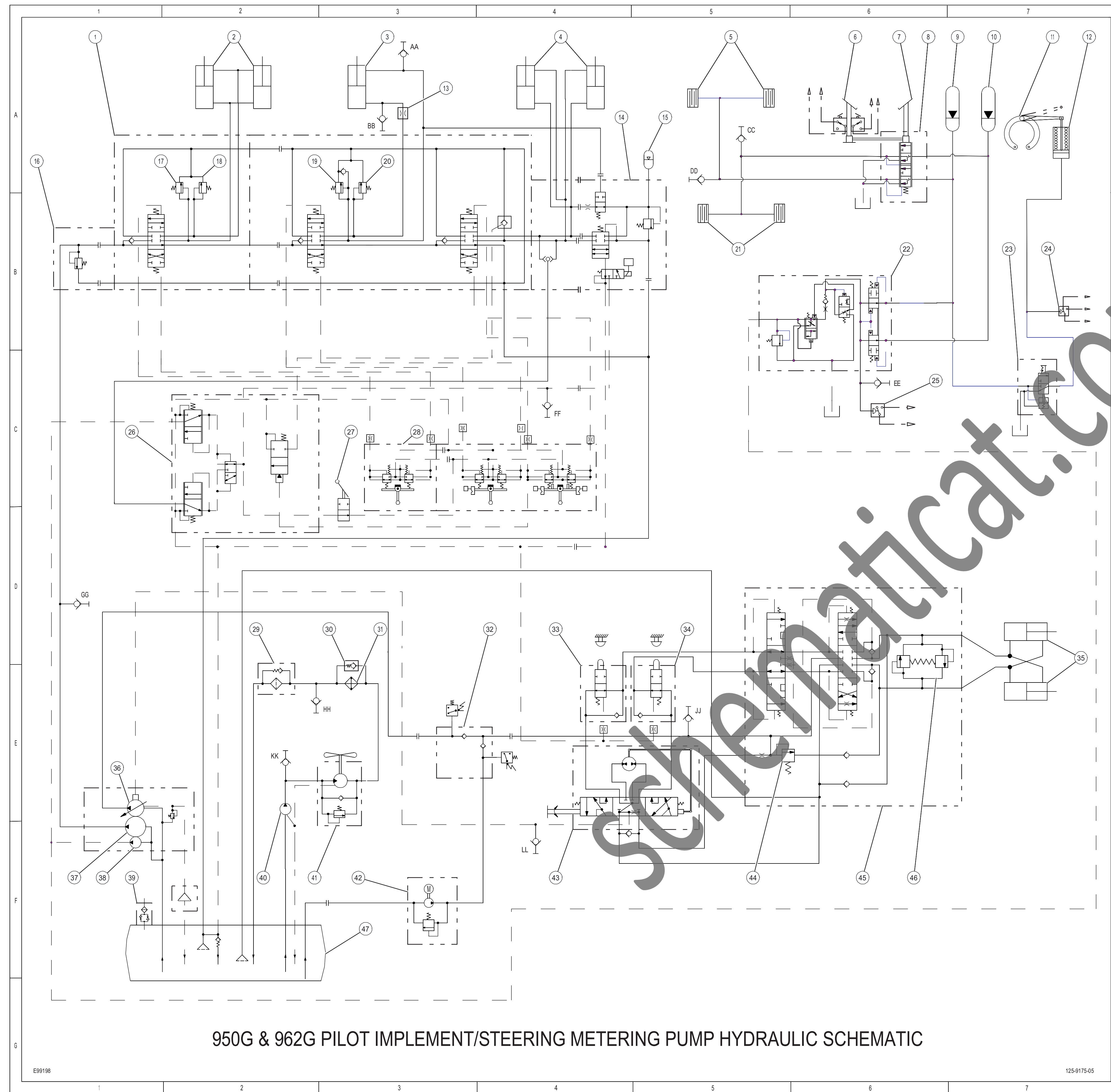

950G & 962G PILOT IMPLEMENT/STEERING METERING PUMP HYDRAULIC SCHEMATIC

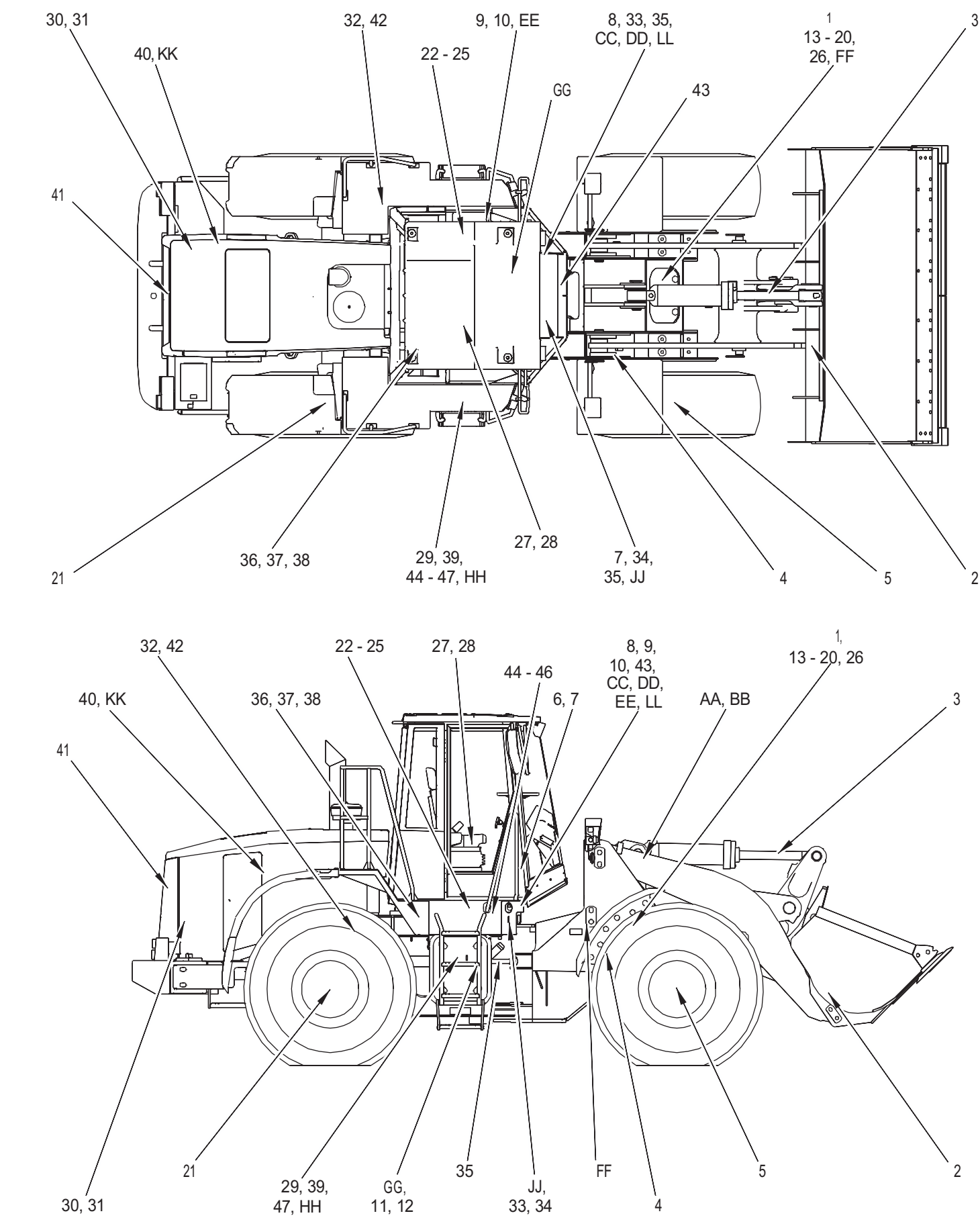

Chart A  
950G and 962G Hydraulic Component Locations

Item No.	Component	Schematic Location
1	Main Control Valve %	A1
2	Auxiliary Cylinders @	A2
3	Tilt Cylinder	A3
4	Lift Cylinders	A4
5	Front Service Brakes	A5
6	Left Pedal Assembly	A6
7	Right Pedal Assembly	A6
8	Service Brake Control Valve	A7
9	Front Service Brakes Accumulator	A7
10	Rear Service Brakes Accumulator	A7
11	Parking Brake	A7
12	Parking Brake Actuator	A3
13	Orifice	A3
14	Ride Control Diverter Valve #	A4
15	Ride Control Accumulator #	A5
16	Main Relief Valve	A1
17	Line Relief Valve (Aux. Cylinder Head End) @	A2
18	Line Relief Valve (Aux. Cylinder Rod End) @	A2
19	Line Relief Valve (Tilt Cylinder Rod End)	A3
20	Line Relief Valve (Tilt Cylinder Head End)	A3
21	Rear Service Brakes	B5
22	Accumulator Charging Valve	B6
23	Parking Brake Control Valve	B7
24	Parking Brake Pressure Switch	B7

Chart A  
950G and 962G Hydraulic Component Locations

Item No.	Component	Schematic Location
25	Service Brake Oil Pressure Switch	C6
26	Pilot Valve (Oil Manifold)	C1
27	Ball Valve (Hydraulic Lever Lock)	C3
28	Pilot Control Valve	D2
29	Hydraulic Oil Filter	D2
30	Hydraulic Oil Cooler Bypass Valve	D3
31	Hydraulic Oil Cooler	D3
32	Secondary Steering Valve *	D4
33	Left Steering Neutralizer Valve	D4
34	Right Steering Neutralizer Valve	D5
35	Steering Cylinders	D7
36	Steering Pump	E1
37	Implement Pump	F1
38	Pilot Brake Pump	F1
39	Breaker Relief Valve	F1
40	Fan Drive Pump	F2
41	Fan Drive Motor	F2
42	Secondary Steering Pump and Electric Motor*	F3
43	Steering Metering Pump	F4
44	Steering Backup Relief Valve	F5
45	Steering Control Valve	F6
46	Steering Crossover Relief Valve	F6
47	Hydraulic Oil Tank	F3

\* Secondary Steering is an optional attachment.  
# Ride Control is an optional attachment.  
@ Auxiliary Cylinders are an optional attachment.  
% The one stem valve (third function) is an optional attachment field conversion.  
The two stem valve is standard.  
The three stem valve is an optional attachment.

Chart B  
950G and 962G Hydraulic Pressure Tap Locations

Pressure Tap	Description	Schematic Location
AA	Tilt Cylinder Rod End Pressure	
BB	Tilt Cylinder Head End Pressure	A3
CC	Rear Service Brake Pressure	
DD	Front Service Brake Pressure	A5
EE	Service Brake Accumulator Pressure	C6
FF	Implement Pilot Pump Pressure	C4
GG	Implement Pump Pressure	D1
HH	Fluid Sampling Valve	E3
JJ	Steering Pump Pressure	E5
KK	Fan Drive Pump Pressure	E2
LL	Steering Signal Pressure	F4